

Welcome dealers for cooperation!



Catalogue

Equipment of our own production

Price for dealers

Company "Food Technologies" has been engaged in manufacturing and sale of equipment and furniture for public catering facilities since 1991. The factory outputs the equipment and furniture, located in the South of Russia, Krasnodar. The range of the manufactured equipment is constantly extending. Production of non-standard equipment according to our Customers' dimensions is possible. The company has the developed branch network all over Russia. The goods are always available at the warehouses of our branches enabling the operative servicing of our Customers. You are welcome for cooperation!

Contents

Thermal Equipment	2-10
- Electric stoves	2
- Gas stoves	5
- Electric frying pans	8
- Oven cabinets	9
Service-counter.....	11-17
- Service-counter "Lira-PROFI"	11
- Service-counter "Self-service buffet"	15
Fast-Food Equipment	18-19
- Döner Kebab Vertical Grill Machine, electric	18
- Deep frying machine for meat pastry (Chiburekki)	18
- Deep frying machine for doughnuts	19
Electromechanical Equipment	20
- Flour sifting and dressing machine, vibratory	20
- Dough sheeter	20
Neutral Equipment	21-44
- Tables.....	21
- Washing sinks	26
- Kitchen racks	31
- Kitchen cabinets	36
- Kitchen shelves	37
- Stands	39
- Trolleys	42
- Range Hood	44



Electric stoves

Electric stove PEP-0.48-DSH

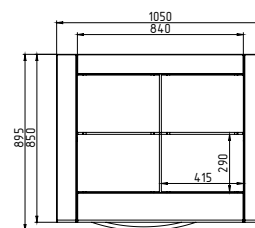
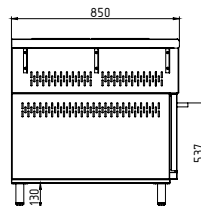
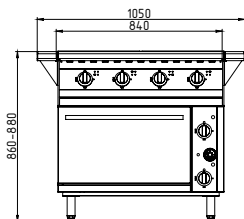

Description:

The stove is equipped with four cast iron burners of the total area 0.48m². The oven has 4 levels for baking sheets. The delivery set comprises 2 baking sheets. Can be used with gastronorm pan GN1/1. The oven has a separate power control of the upper and lower heating elements. The oven automatically maintains the set temperature from 50 to 300°C. The oven is equipped with control from overheating over 300°C. The oven is equipped with adjustable legs. The product is supplied assembled on a pallet. Packing is corrugated board and wooden frame.

Character description	PEP-0.48-DSH	PEP-0.48-DSH-N304	PEP-0.48-DSH-N430	PEP-0.48-DSH-304-St3	PEP-0.48-DSH-430-St3
Body frame material	AISI 430/ galv. steel	AISI 304	AISI 430	AISI 304	AISI 430
Baking chamber material	mild steel	AISI 304	AISI 430	mild steel	mild steel
Area of heating surface, m ²	0,48				
Rated capacity, kW	16,8				
Rated capacity of heating elements, kW	4,8				
Inner chamber dimensions , not more than (L*W*H), mm	538x535x290				
Dimensions (LxWxH), mm	840(1050)x850(895)x860-880				
Package dimensions (L*W*H),mm	970x1000x1095				
Weight, kg	131				
Dealer Price (EXW), \$	521	737,6	661,2	684	627

Electric stove PEP-0.72-DSH

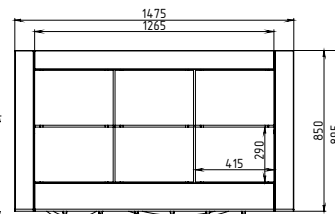
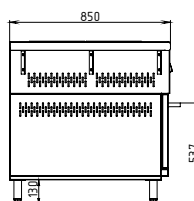
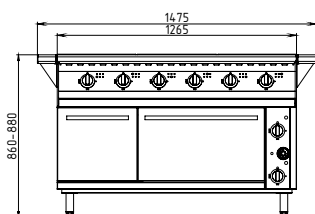

Description:

The stove is equipped with six cast iron burners of the total area 0.72m². The oven has 4 levels for baking sheets. The delivery set comprises 2 baking sheets made of iron. Can be used with gastronorm pan GN1/1. The oven has a separate power control of the upper and lower heating elements. The oven automatically maintains the set temperature from 50 to 300°C. The oven is equipped with the overheat control from overheating over 300°C. To the left of the oven, there is a metal box for cooking utensils storage. The oven is equipped with adjustable legs. The product is supplied assembled on a pallet. Packing is corrugated board and wooden frame.

Character description	PEP-0.72-DSH	PEP-0.72-DSH-N304	PEP-0.72-DSH-N430	PEP-0.72-DSH-304-St3	PEP-0.72-DSH-430-St3
Body frame material	AISI 430/ galv. steel	AISI 304	AISI 430	AISI 304	AISI 430
Baking chamber material	mild steel	AISI 304	AISI 430	mild steel	mild steel
Area of heating surface, m ²	0,72				
Rated capacity, kW	22,8				
Rated capacity of heating elements, kW	4,8				
Inner chamber dimensions , not more than (L*W*H), mm	538x535x290				
Dimensions (LxWxH), mm	1265(1475)x850(895)x860-880				
Package dimensions (L*W*H),mm	1390x1010x1100				
Weight, kg	178				
Dealer Price (EXW), \$	777,5	1054,5	958,7	1000,9	920



Electric stove PEP-0.48

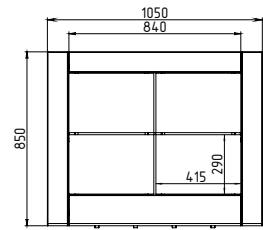
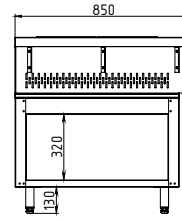
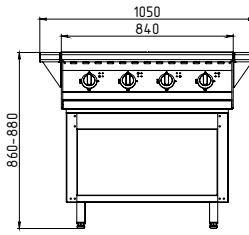

Description:

The stove is equipped with four cast iron burners of the total area 0.48m². The cooktop has three levels of burners' capacity control. The cooktop is equipped with adjustable legs. The product is supplied assembled on a pallet. Packing is corrugated board and wooden frame.

Character description	PEP-0,48	PEP-0,48-N304	PEP-0,48-N430
Body frame material	AISI 430/ galv. steel	AISI 304	AISI 430
Area of heating surface, m ²	0,48		
Rated capacity, kW	11,8		
Rated capacity of heating elements, kW	-		
Inner chamber dimensions , not more than (L*W*H), mm	-		
Dimensions (LxWxH), mm	840(1050)x850(895)x860-880		
Package dimensions (L*W*H),mm	970x1000x1095		
Weight, kg	90		
Dealer Price (EXW), \$	381,9	534,7	483,4

Electric stove PEP-0.72

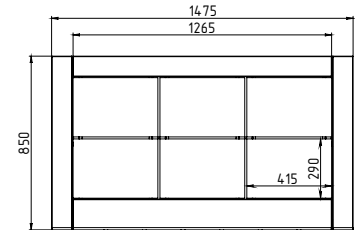
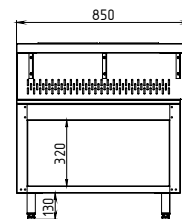
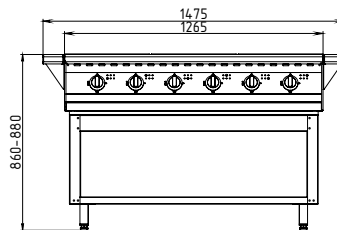

Description:

The stove is equipped with six cast iron burners of the total area 0.48m². The cooktop has three levels of burners' capacity control. The cooktop is equipped with adjustable legs. The product is supplied assembled on a pallet. Packing is corrugated board and wooden frame.

Character description	PEP-0,72	PEP-0,72-N304	PEP-0,72-N430
Body frame material	AISI 430/ galv. steel	AISI 304	AISI 430
Area of heating surface, m ²	0,72		
Rated capacity, kW	16,8		
Rated capacity of heating elements, kW	-		
Inner chamber dimensions , not more than (L*W*H), mm	-		
Dimensions (LxWxH), mm	1265(1475)x850(895)x860-880		
Package dimensions (L*W*H),mm	1390x1010x1100		
Weight, kg	129		
Dealer Price (EXW), \$	526,7	721,6	658,9



Electric stove PEP-0,24M

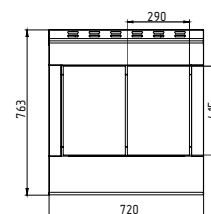

Description:

The stove is equipped with four cast iron burners of the total area 0.24m². The cooktop has three levels of burners' capacity control. The cooktop sets on a table. Packing is corrugated board.

Character description	PEP-0,24M	PEP-0,24M-N304	PEP-0,24M-N430
Body frame material	AISI 430/ galv. steel	AISI 304	AISI 430
Number of hot plates	2		
Rated capacity, kW	6		
Area of heating surface, m ²	0,24		
Nominal power, V	380		
Max. temperature of hot plate, C	400		
Dimensions (LxWxH), mm	720x763x325		
Weight, kg	45		
Dealer Price (EXW), \$	216,6	255,4	244

Electric stove PEP-0,17M

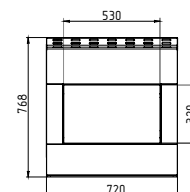
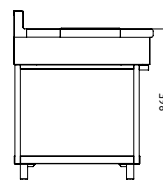
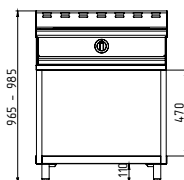

Description:

The stove is equipped with four cast iron burners of the total area 0.17m². The cooktop has three levels of burners' capacity control. The cooktop is equipped with adjustable legs. The product is supplied assembled on a pallet. Packing is corrugated board and wooden frame.

Character description	PEP-0,17M	PEP-0,17M-N304	PEP-0,17M-N430
Body frame material	AISI 430/ galv. steel	AISI 304	AISI 430
Area of heating surface, m ²	0,17		
Rated capacity, kW	4		
Rated capacity of heating elements, kW	-		
Inner chamber dimensions , not more than (L*W*H), mm	-		
Dimensions (LxWxH), mm	720x770x950-970		
Package dimensions (L*W*H),mm	730x770x850		
Weight, kg	56		
Dealer Price (EXW), \$	213,2	304,4	269



Gas stoves

Gas stove PG-4D

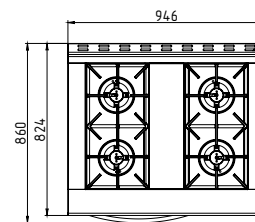
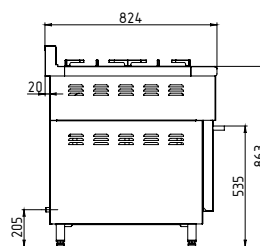
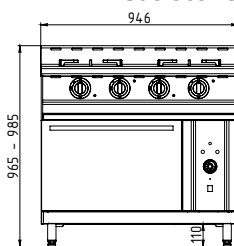

Description:

The stove is equipped with four burners. The capacity of one burner is 3.5 kW. The stove and oven are fitted with electrical ignition and "gas-control" system. The capacity of an oven burner is 6 kW. The oven has 4 levels for baking sheets sized 540x470 mm. The oven automatically maintains the set temperature from 50 to 300°C. The delivery set comprises 2 baking sheets of mild steel sized 540x470x40 mm and a set of jets for different types of gas. The front and upper parts of the stove are made of stainless steel AISI 430, the other parts are made of steel painted with grey resistant paint. The oven is equipped with adjustable legs. The product is supplied assembled on a pallet. Packing is corrugated board and wooden frame.

Character description	PG-4D	PG-4D-N304	ПГ-4Д-N430	PG-4D-304-St3	PG-4D-430-St3
Body frame material	AISI430/galv. steel	AISI 304	AISI 430	AISI 304	AISI 430
Baking chamber material	mild steel	AISI 304	AISI 430	mild steel	mild steel
Number of burners	4				
Rated capacity, kW	20				
Rated capacity of one top plate burner, kW	3,5				
Rated capacity of one oven burner, kW	6				
Gas consumption by one top plate burner, m ³ /hr	0,195				
Gas consumption by one oven burner, m ³ /hr	0,4				
Rated voltage, V	220				
Dimensions (LxWxH), mm	946x860x965-985				
Weight, kg	112				
Dealer Price (EXW), \$	878,9	1089,8	1024,9	1014,6	969

Gas stove PG-6D

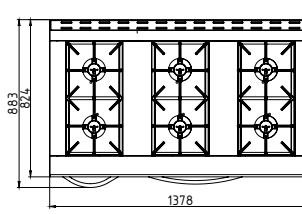
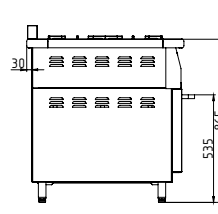
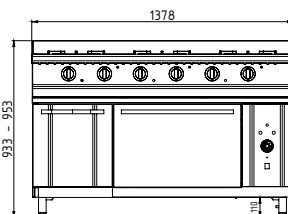

Description:

The stove is equipped with six burners. The capacity of one burner is 3.5 kW. The stove and oven are fitted with electrical ignition and "gas-control" system. The capacity of an oven burner is 6 kW. The oven has 4 levels for baking sheets sized 540x470 mm. The oven automatically maintains the set temperature from 50 to 300°C. The delivery set comprises 2 baking sheets of mild steel sized 540x470x40 mm and a set of jets for different types of gas. The front and upper parts of the stove are made of stainless steel AISI 430, the other parts are made of steel painted with grey resistant paint. On the left side of the oven, there is a metal box for cooking utensils storage. The oven is equipped with adjustable legs. The product is supplied assembled on a pallet. Packing is corrugated board and wooden frame.

Character description	PG-6D	PG-6D-N304	PG-6D-N430	PG-6D-304-St3	PG-6D-430-St3
Body frame material	AISI430/galv. steel	AISI 304	AISI 430	AISI 304	AISI 430
Baking chamber material	mild steel	AISI 304	AISI 430	mild steel	mild steel
Number of burners	6				
Rated capacity, kW	27				
Rated capacity of one top plate burner, kW	3,5				
Rated capacity of one oven burner, kW	6				
Gas consumption by one top plate burner, m ³ /hr	0,195				
Gas consumption by one oven burner, m ³ /hr	0,4				
Rated voltage, V	220				
Dimensions (LxWxH), mm	1378x883x933-953				
Weight, kg	142				
Dealer Price (EXW), \$	1124	1389,7	1304,2	1309,9	1247,2



Gas stove PG-2

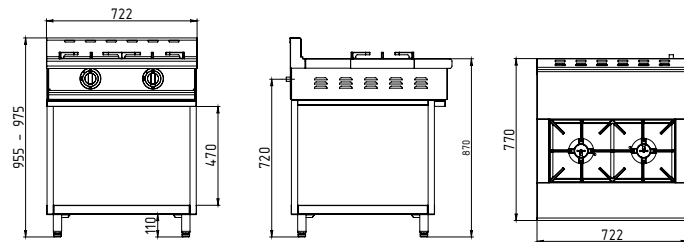

Description:

The stove is equipped with two burners. The capacity of one burner is 3.5 kW. The stove is fitted with electrical ignition and "gas-control" system. The delivery set comprises a set of jets for different types of gas. The product is supplied assembled on a pallet. The front and upper plates of the stove are made of stainless steel AISI 430, the other parts are made of mild steel painted with grey resistant paint. The oven is equipped with adjustable legs. Packing is corrugated board and wooden frame.

Character description	PG-2	PG-2-N304	PG-2-N430
Body frame material	AISI 430/ galv. steel	AISI 304	AISI 430
Number of burners		2	
Rated capacity, kW		7	
Rated capacity of one top plate burner, kW		3,5	
Gas consumption by one oven burner, m ³ /hr		0,195	
Dimensions (LxWxH), mm		722x770x955-975	
Weight, kg		38	
Dealer Price (EXW), \$	344,3	427,5	395,6

Gas stove PG-4

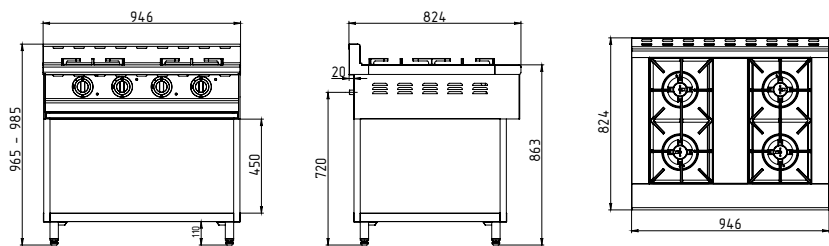

Description:

The stove is equipped with four burners. The capacity of one burner is 3.5 kW. The stove is fitted with electrical ignition and "gas-control" system. The delivery set comprises a set of jets for different types of gas. The product is supplied assembled on a pallet. The front and upper plates of the stove are made of stainless steel AISI 430, the other parts are made of mild steel painted with grey resistant paint. The oven is equipped with adjustable legs. Packing is corrugated board and wooden frame.

Character description	PG-4	PG-4-N304	PG-4-N430
Body frame material	AISI 430/ galv. steel	AISI 304	AISI 430
Number of burners		4	
Rated capacity, kW		14	
Rated capacity of one top plate burner, kW		3,5	
Gas consumption by one oven burner, m ³ /hr		0,195	
Dimensions (LxWxH), mm		946x824x965-985	
Weight, kg		50	
Dealer Price (EXW), \$	501,6	593,9	555,2



Gas stove PG-6

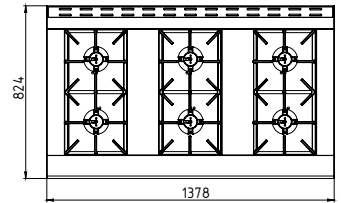
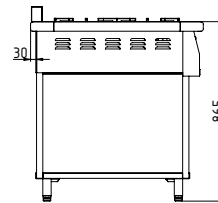
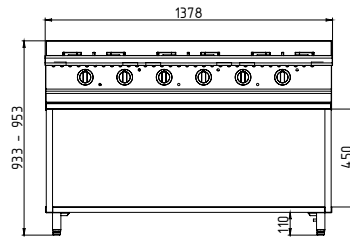

Description:

The stove is equipped with six burners. The capacity of one burner is 3.5 kW. The stove is fitted with electrical ignition and "gas-control" system. The delivery set comprises a set of jets for different types of gas. The product is supplied assembled on a pallet. The front and upper plates of the stove are made of stainless steel AISI 430, the other parts are made of mild steel painted with grey resistant paint. The oven is equipped with adjustable legs. Packing is corrugated board and wooden frame.

Character description	PG-6	PG-6-N304	PG-6-N430
Body frame material	AISI 430/ galv. steel	AISI 304	AISI 430
Number of burners	6		
Rated capacity, kW	21		
Rated capacity of one top plate burner, kW	3,5		
Gas consumption by one oven burner, m ³ /hr	0,195		
Dimensions (LxWxH), mm	1378x824x933-953		
Weight, kg	80		
Dealer Price (EXW), \$	726,2	849,3	800,3



Electric frying pan

Description:

The front and upper parts of the pan are made of stainless steel AISI 430, the other parts and the frame are made form steel painted with grey resistant paint. The bowl is made of cast iron. The frying surface automatically maintains the set temperature from 20° to 275°C. The oven is equipped with the overheat control from overheating over 300°C. It is Provided with the bowl lifting and lowering mechanism by a rotating handle. The pan is equipped with adjustable feet. The product is supplied assembled on a pallet. Packing is corrugated board and wooden frame.

Electric frying pan SEP-0,25

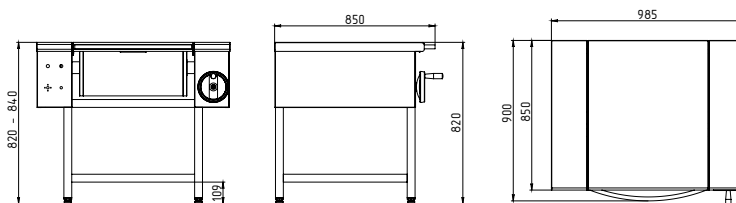

Electric frying pan SEP-0,45

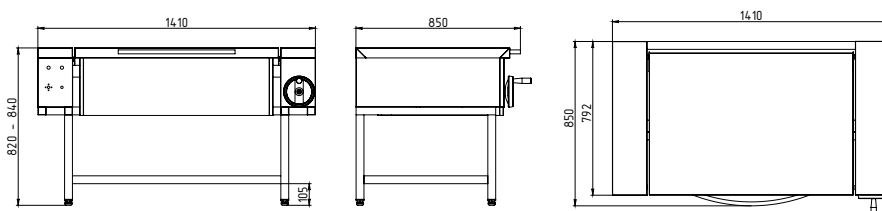

Character description	SEP-0,25-M	SEP-0,25-M-N304	SEP-0,25-M-N430
Body frame material	AISI 430/ galv. steel	AISI 304	AISI 430
Bowl volume, L		35	
Rated capacity, kW		6	
Rated voltage, V		380B	
Dimensions (LxWxH), mm		985x850(900)x820-840	
Weight, kg		142	
Dealer Price (EXW), \$	627	819,7	770,6

Character description	SEP-0,45-M	SEP-0,45-M-N304	SEP-0,45-M-N430
Body frame material	AISI 430/ galv. steel	AISI 304	AISI 430
Bowl volume, L		65	
Rated capacity, kW		12	
Rated voltage, V		380B	
Dimensions (LxWxH), mm		1430x850(900)x820-840	
Weight, kg		208	
Dealer Price (EXW), \$	793,4	1024,9	965,6

Oven cabinets

Oven cabinets depending on manufacturing materials are produced in two series: ECONOM and STANDARD. Oven cabinets of ECONOM series the front and upper part of the stove are made of stainless steel, the other parts are from steel painted with grey resistant paint. Oven cabinets of STANDARD series are completely made from stainless steel. The stand frame for oven cabinets is made of galvanized steel angle. The shelf in the stand for ECONOMY series is made of galvanized steel, in STANDARD series – of stainless steel.

Oven cabinet SHEZHP-1

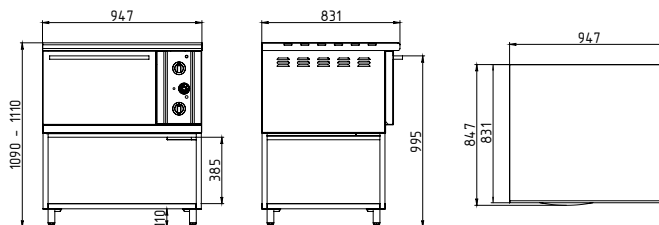

Description:

The oven has 3 levels for baking sheets sized 530x470x30 mm. The delivery set comprises 2 baking sheets of iron sized 530x470x30 mm. Can be used with gastronorm pan GN1/1. The oven has a separate power control of the upper and lower heating elements. The oven automatically maintains the set temperature from 50 to 300°C. The oven is equipped with control from overheating over 300°C. The cabinet is mounted on the stand. The product is supplied assembled on a pallet. Packing is corrugated board and wooden frame.

Наименование параметра	SHEZHP-1	SHEZHP-1-N304	SHEZHP-1-N430	SHEZHP-1-304-St3	SHEZHP-1-430-St3
Body frame material	AISI430/galv. steel	AISI 304	AISI 430	AISI 304	AISI 430
Baking chamber material	mild steel	AISI 304	AISI 430	mild steel	mild steel
Number of levels	3				
Rated capacity, kW	5				
Rated voltage, V	220B				
Dimensions (LxWxH), mm	947x847x1090-1110				
Weight, kg	83				
Dealer Price (EXW), \$	302,1	514,1	437,8	460,6	399

Oven cabinet SHEZHP-2

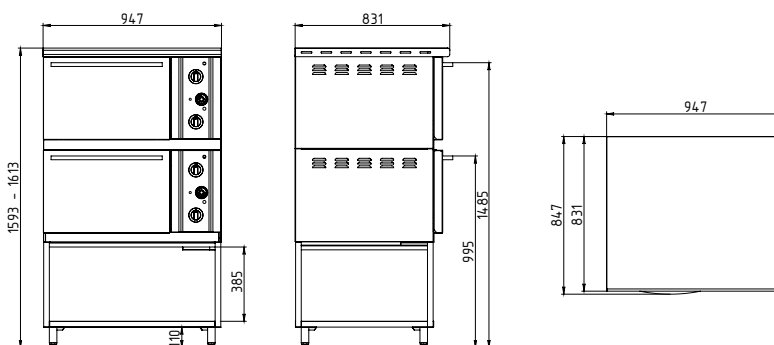

Description:

The oven has 6 levels for baking sheets sized 530x470x30 mm. The delivery set comprises 4 baking sheets of iron sized 530x470x30 mm. Can be used with gastronorm pan GN1/1. The oven has a separate power control of the upper and lower heating elements. The oven automatically maintains the set temperature from 50 to 300°C. The oven is equipped with control from overheating over 300°C. The cabinet is mounted on the stand. The product is supplied assembled on a pallet. Packing is corrugated board and wooden frame.

Наименование параметра	SHEZHP-2	SHEZHP-2-N304	SHEZHP-2-N430	SHEZHP-2-304-St3	SHEZHP-2-430-St3
Body frame material	AISI430/galv. steel	AISI 304	AISI 430	AISI 304	AISI 430
Baking chamber material	mild steel	AISI 304	AISI 430	mild steel	mild steel
Number of levels	6				
Rated capacity, kW	10				
Rated voltage, V	380B				
Dimensions (LxWxH), mm	947x847x1593-1613				
Weight, kg	170				
Dealer Price (EXW), \$	552,9	885,8	766,1	780,9	689,7



Oven cabinet SHEZHP-3

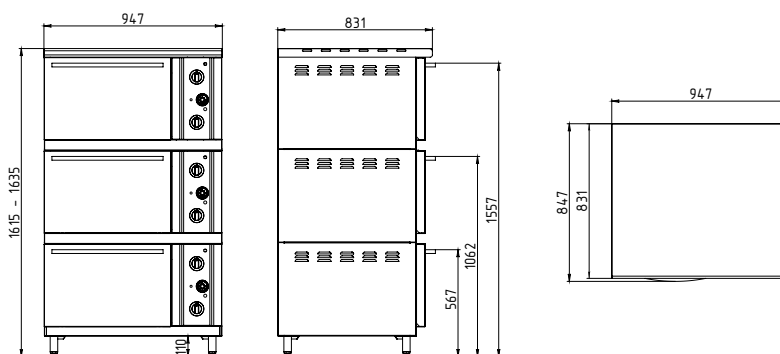

Description:

The oven cabinet has 9 levels for baking sheets sized 530x470x30 mm. The delivery set comprises 6 baking sheets of iron sized 530x470x30 mm. Can be used with gastronorm pan GN1/1. The oven has a separate power control of the upper and lower heating elements. The oven automatically maintains the set temperature from 50 to 300°C. The oven is equipped with control from overheating over 300°C. The cabinet is mounted on the stand. The product is supplied assembled on a pallet. Packing is corrugated board and wooden frame.

Character description	SHEZHP-3	SHEZHP-3-N304	SHEZHP-3-N430	SHEZHP-3-304-St3	SHEZHP-3-430-St3
Body frame material	AISI430/galv. steel	AISI 304	AISI 430	AISI 304	AISI 430
Baking chamber material	mild steel	AISI 304	AISI 430	mild steel	mild steel
Number of levels	9				
Rated capacity, kW	15				
Rated voltage, V	380B				
Dimensions (LxWxH), mm	947x847x1615-1635				
Weight, kg	235				
Dealer Price (EXW), \$	671,5	1069,3	925,7	923,4	811,7

Oven cabinet SHZHG-1

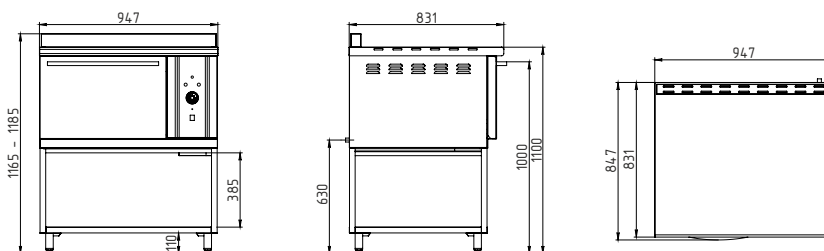

Description:

The oven cabinet is fitted with electrical ignition and "gas-control" system. The capacity of an oven burner is 6 kW. The oven has 4 levels for baking sheets sized 540x470 mm. The oven automatically maintains the set temperature from 50 to 300°C. The delivery set comprises 2 baking sheets of iron sized 540x470x40 mm and a set of jets for different types of gas. The cabinet is equipped with adjustable legs. The product is supplied assembled on a pallet. Packing is corrugated board and wooden frame.

Character description	SHZHG-1	SHZHG-1-N304	SHZHG-1-N430	SHZHG-1-304-St3	SHZHG-1-430-St3
Body frame material	AISI430/galv. steel	AISI 304	AISI 430	AISI 304	AISI 430
Baking chamber material	mild steel	AISI 304	AISI 430	mild steel	mild steel
Number of levels	4				
Rated capacity, kW	6				
Rated voltage, V	220B				
Dimensions (LxWxH), mm	947x847x1165-1185				
Weight, kg	105				
Dealer Price (EXW), \$	388,7	603,1	536,9	534,7	486,8

Service-counter

The line is completely made of stainless steel AISI 430. Gastronorm pans are made of stainless steel pipe and are included in the delivery set of each element.

Food warmer for soups Lira-PROFI/MEP-1B-2

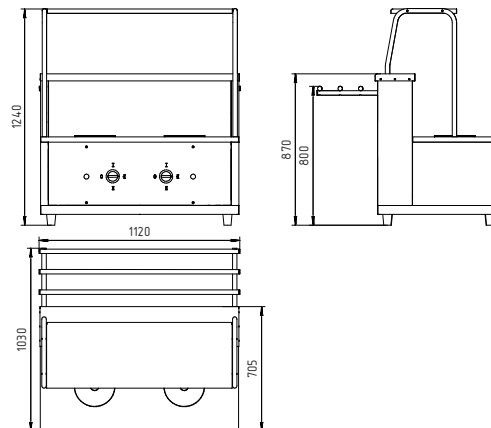

Food warmer for soups Lira-PROFI/MEP-1B-3

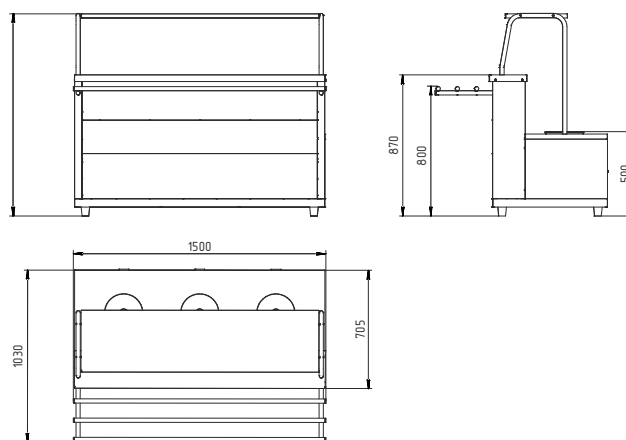

Description:

Equipped with 2 or 3 electric ranges. Each range has 3 heating levels. The food warmer is equipped with adjustable legs. The product is supplied assembled on a pallet. Packing is corrugated board and wooden frame.

Character description	Lira-PROFI MEP-1B-2	Lira-PROFI MEP-1B-2-N304	Lira-PROFI MEP-1B-2-N430	Lira -PROFI MEP-1B-3	Lira -PROFI MEP-1B-3-N304	Lira -PROFI MEP-1B-3-N430
Body frame material	AISI430/galv. steel	AISI 304	AISI 430	AISI430/galv. steel	AISI 304	AISI 430
Type	For first courses			For first courses		
Number of ranges/pans	2			3		
Heating type	Electric range			Electric range		
Consumed capacity, kW	2			3		
Power supply	400/230B			400/230B		
Dimensions (LxWxH), mm	1120x705(1030)x870(1240)			1500x705(1030)x870(1240)		
Weight, kg	60			86		
Dealer Price (EXW), \$	393,3	472	407	524,4	631,6	546,1

Food warmer for main courses Lira-PROFI/MEP-2B-P

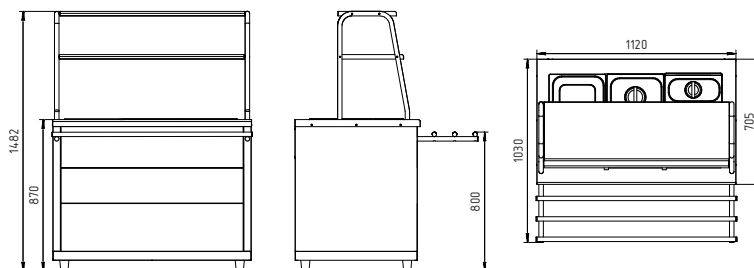

Description:

Food warmer for main courses with 6 gastronorm pans MEP-2B-P

Equipped with 6 gastronorm pans 150 mm deep. The gastronorm pans are included in the set. Heating method is dry. Smooth heating temperature control from 0 to 90°C. There is a space for kitchen utensils storage below. The food warmer is equipped with legs adjustable by height. The product is supplied assembled on a pallet. Packing is corrugated board and wooden frame.

Food warmer for main courses with 6 gastronorm pans, steam MEP-2B-P (steam)

Equipped with 6 gastronorm pans 150 mm deep. The gastronorm pans are included in the set. Heating method is a hot steam. Smooth heating temperature control from 0 to 90°C. There is a space for kitchen utensils storage below. The food warmer is equipped with legs adjustable by height. The product is supplied assembled on a pallet. Packing is corrugated board and wooden frame.

Character description	Lira -PROFI MEP-2B-P (steam)	Lira -PROFI MEP-2B-P-N304 (steam)	Lira -PROFI MEP-2B-P-N430 (steam)
Body frame material	AISI430/galv. steel	AISI 304	AISI 430
Type	For main courses		
Number of ranges/pans	6 gastronorm pans		
Heating type	Steam		
Consumed capacity, kW	2		
Power supply	230B		
Dimensions (LxWxH), mm	1120x705(1030)x870(1482)		
Weight, kg	65		
Dealer Price (EXW), \$	677,2	755,8	688,6

Refrigerated table with glass window Lira-PROFI/SOEP-V

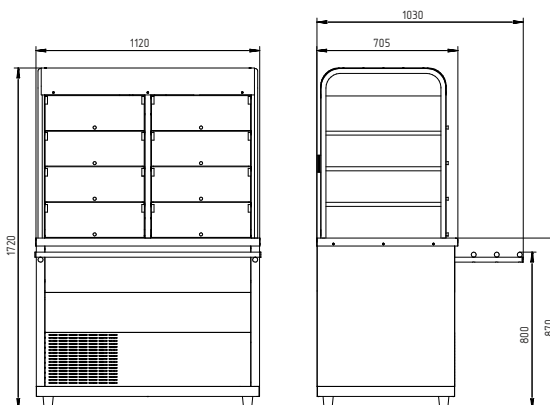

Description:

Made of stainless steel AISI 430. Equipped with perforated shelves. The window is made of Plexiglas and illuminated. Smooth temperature control from 0 to 10°C. There is a space for kitchen utensils storage below. The table is equipped with legs adjustable by height. The product is supplied assembled on a pallet. Packing is corrugated board and wooden frame.

Character description	Lira-PROFI/SOEP-V	Lira-PROFI/SOEP-V-N304	Lira-PROFI/SOEP-V-N430	Lira-PROFI/SOEP-V	Lira-PROFI/SOEP-V-N304	Lira-PROFI/SOEP-V-N430
Body frame material	AISI430/galv. steel	AISI 304	AISI 430	AISI430/galv. steel	AISI 304	AISI 430
Type	Closed (window)			Closed (window)		
Maintained temperature, C	от +1 до +10			от +1 до +10		
Consumed capacity, kW	0,6			0,6		
Power supply	230B			230B		
Dimensions (LxWxH), mm	1120x705(1030)x1720			1500x705(1030)x1720		
Weight, kg	140			180		
Dealer Price (EXW), \$	1146,8	1260,8	1169,6	1285,9	1427,3	1322,4

Refrigerated table

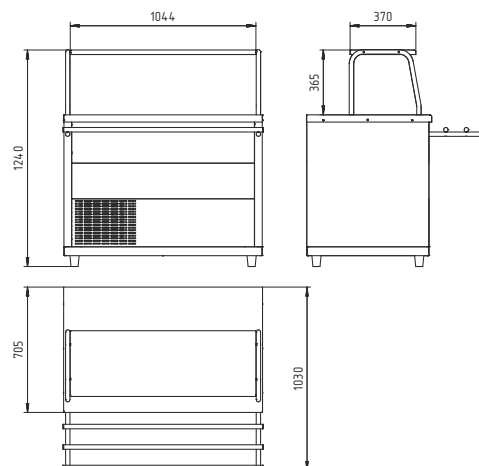

Description:

Made of stainless steel AISI 430. Intended for distribution to consumers of bakery and confectionery products and drinks. The table is equipped with legs adjustable by height. The product is supplied assembled on a pallet. Packing is corrugated board and wooden frame.

Character description	Lira-PROFI/SOEP	Lira-PROFI/SOEP-N304	Lira-PROFI/SOEP-N430
Body frame material	AISI430/galv. steel	AISI 304	AISI 430
Type	Open		
Maintained temperature, C	from +1 to +10		
Consumed capacity, kW	7		
Power supply	230B		
Dimensions (LxWxH), mm	1120x705(1030)x1240		
Weight, kg	85		
Dealer Price (EXW), \$	677,2	750,1	694,3

Cutlery stand SP/Lira-PROFI

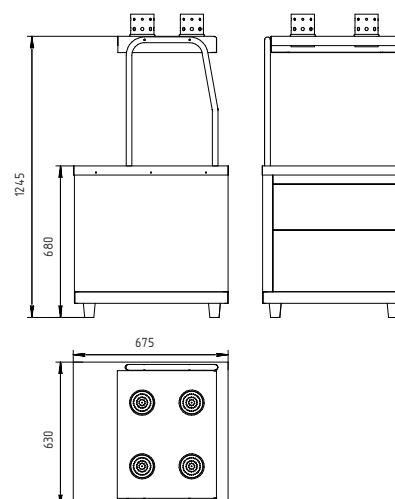

Description:

Made of stainless steel AISI 430. Intended for distribution to consumers of trays and cutlery. There is a space under the tabletop for kitchen utensils and trays storage. The stand is equipped with legs adjustable by height. The product is supplied assembled on a pallet. Packing is corrugated board and wooden frame.

Character description	SP/Lira-PROFI	SP/Lira-PROFI-N304	SP/Lira-PROFI-N430
Body frame material	AISI430/galv. steel	AISI 304	AISI 430
Dimensions (LxWxH), mm	630x680x1245		
Weight, kg	24		
Dealer Price (EXW), \$	233,7	273,6	234,8

Cash register counter SK/Lira-PROFI

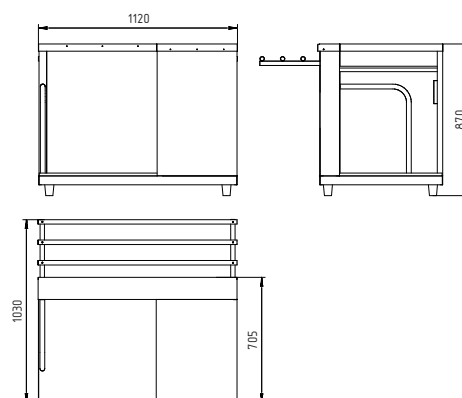
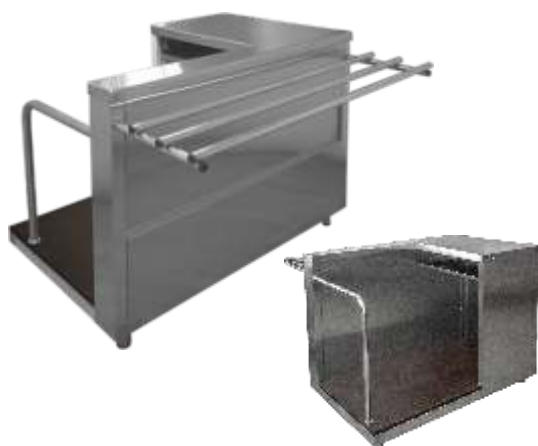

Description:

Made of stainless steel AISI 430. Intended for cash register installation and payment with customers. There is a 220V socket below for cash register power supply. The counter is equipped with legs adjustable by height. The product is supplied assembled on a pallet. Packing is corrugated board and wooden frame.

Character description	SK/Lira-PROFI	SK/Lira-PROFI-N304	SK/Lira-PROFI-N430
Body frame material	AISI430/galv. steel	AISI 304	AISI 430
Dimensions (LxWxH), mm	1120x705(1030)x870		
Weight, kg	50		
Dealer Price (EXW), \$	262,2	318,1	262,2

Neutral table SN/Lira-PROFI

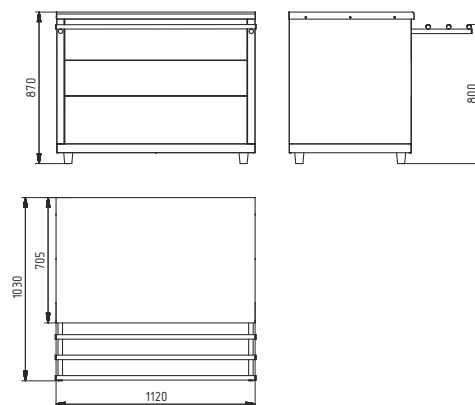

Description:

Made of stainless steel AISI 430. Intended for distribution to consumers of bakery and confectionery products and drinks. The table is equipped with legs adjustable by height. The product is supplied assembled on a pallet. Packing is corrugated board and wooden frame.

Character description	SN/Lira-PROFI	SN/Lira-PROFI-N304	SN/Lira-PROFI-N430	SN/Lira-PROFI-70	SN/Lira-PROFI-70-N304	SN/Lira-PROFI-70-N430
Body frame material	AISI430/galv. steel	AISI 304	AISI 430	AISI430/galv. steel	AISI 304	AISI 430
Dimensions (LxWxH), mm	1120x705(1030)x870			630x680x1245		
Weight, kg	40			24		
Dealer Price (EXW), \$	273,6	315,8	271,3	228	267,9	250,8

Service-counter "Self-service buffet", mobile

The frame of elements is made of laminated chipboard coloured "walnut" or "beechwood" and from stainless steel AISI 430. It can be manufactured with natural stone tabletop.

Self-service buffet MEP-2B-SHS

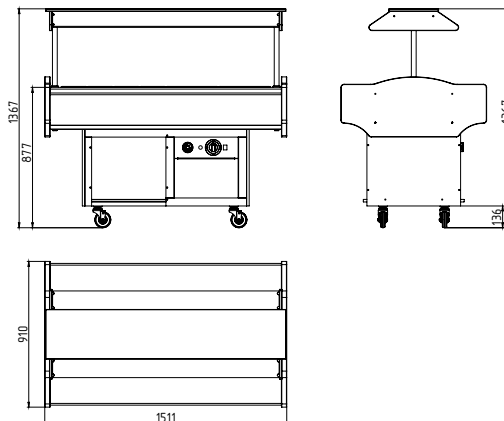

Description:

Equipped with 12 gastronorm pans 150 mm deep. The gastronorm pans are included in the set. Smooth heating temperature is from 0 to 90°C. There is a space for kitchen utensils storage below. The food warmer is equipped with legs adjustable by height. The product is supplied assembled on a pallet. Packing is corrugated board and wooden frame.

Self-service buffet SOEP-SHS

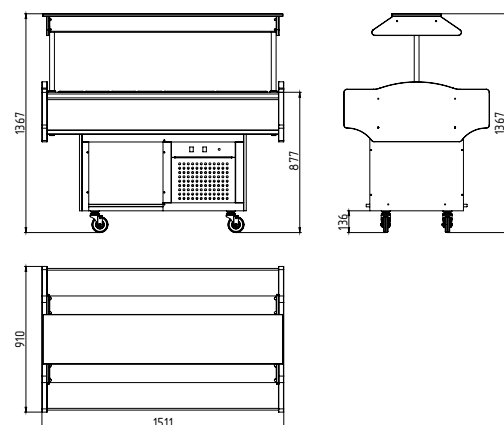

Description:

Equipped with 12 gastronorm pans 150 mm deep. The gastronorm pans are included in the set. Smooth heating temperature is from -1 to +5°C. There is an open space for kitchen utensils storage below. The buffet is equipped with legs adjustable by height. The product is supplied assembled on a pallet. Packing is corrugated board and wooden frame.

Character description	MEP-2B-SHS	MEP-2B-SHS-N304	MEP-2B-SHS-N430	SOEP-SHS	SOEP-SHS-N304	SOEP-SHS-N430
Body frame material	AISI430/galv. steel	AISI 304	AISI 430	AISI430/galv. steel	AISI 304	AISI 430
Type	Heated for the main course, 12 gastronorm pans			Refrigerated, gastronorm pans 12		
Material	Laminated chipboard + stainless steel			Laminated chipboard + stainless steel		
Maintained temperature, C	from 0 to +90			from -1 to +5 (surface temperature)		
Consumed capacity, kW	2			0,37		
Power supply	220/380B			220/380B		
Dimensions (LxWxH), mm	1511x910x1367			1511x910x1367		
Weight, kg	110			142		
Dealer Price (EXW), \$	684	811,7	775,2	943,9	1077,3	1046,5

Self-service buffet MEP-2B-SHS-G

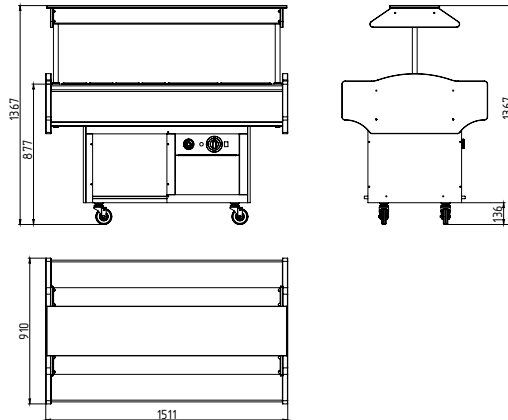

Description:

Equipped with 12 gastronorm pans 150 mm deep. The gastronorm pans are included in the set. Smooth heating temperature is from 0 to 90°C. There is a space for kitchen utensils storage below. Tabletop coated with granite. The food warmer is equipped with legs adjustable by height. The product is supplied assembled on a pallet. Packing is corrugated board and wooden frame.

Self-service buffet SOEP-SHS-G

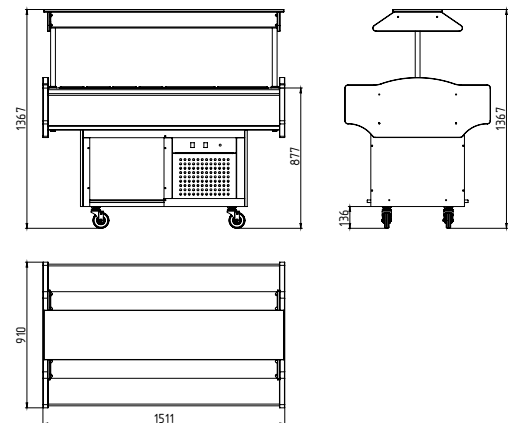

Description:

Equipped with 12 gastronorm pans 150 mm deep. The gastronorm pans are included in the set. Smooth heating temperature is from -1 to +5°C. There is an open space for kitchen utensils storage below. Tabletop coated with granite. The buffet is equipped with legs adjustable by height. The product is supplied assembled on a pallet. Packing is corrugated board and wooden frame.

Character description	MEP-2B-SHS-G	MEP-2B-SHS-G-N304	MEP-2B-SHS-G-N430	SOEP-SHS-G	SOEP-SHS-G-N304	SOEP-SHS-G-N430
Body frame material	AISI430/galv. steel	AISI 304	AISI 430	AISI430/galv. steel	AISI 304	AISI 430
Type	Heated for the main course, 12 gastronorm pans			Refrigerated, gastronorm pans 12		
Material	Laminated chipboard + stainless steel + tabletop coated with granite			Laminated chipboard + stainless steel + tabletop coated with granite		
Maintained temperature, C	from 0 to +90			from -1 to +5 (surface temperature)		
Consumed capacity, kW	2			0,37		
Power supply	220/380B			220/380B		
Dimensions (LxWxH), mm	1511x910x1367			1511x910x1367		
Weight, kg	144			181		
Dealer Price (EXW), \$	829,9	991,8	940,5	1091,0	1311,0	763,8

Self-service buffet SN-SHS

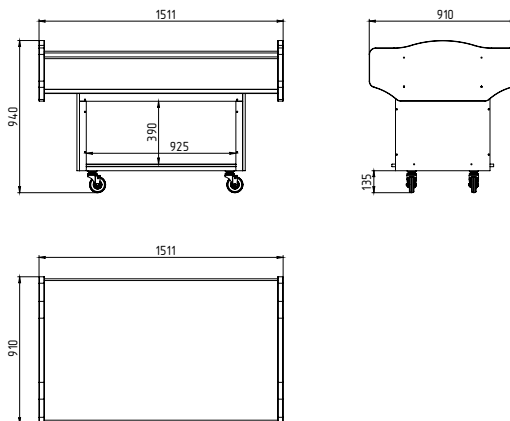

Description:

Intended for distribution to consumers of bakery and confectionery products and drinks thermostat installation. The table is equipped with legs adjustable by height. The product is supplied assembled on a pallet. Packing is corrugated board and wooden crate frame.

Character description	SN-SHS	SN-SHS-N304	SN-SHS-N430
Body frame material	AISI430/galv. steel	AISI 304	AISI 430
Volume	1,936 м ³		
Material	Laminated chipboard + stainless steel		
Dimensions (LxWxH), mm	1511x910x940		
Weight, kg	76		
Dealer Price (EXW), \$	415	487,9	470,8

Self-service buffet SN-SHS-G

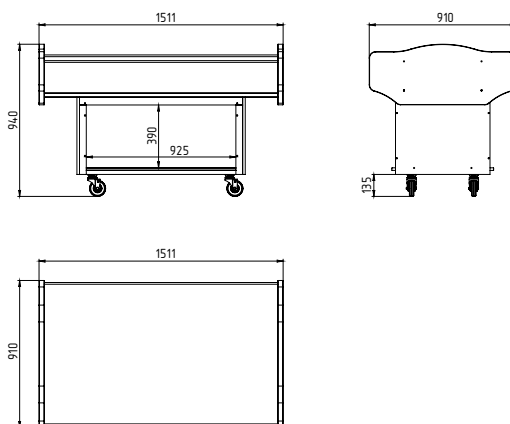

Description:

Intended for distribution to consumers of bakery and confectionery products and drinks thermostat installation. Tabletop coated with granite. The food warmer is equipped with legs adjustable by height. The product is supplied assembled on a pallet. Packing is corrugated board and wooden crate frame.

Character description	SN-SHS-G	SN-SHS-G-N304	SN-SHS-G-N430
Body frame material	AISI430/galv. steel	AISI 304	AISI 430
Volume	1,936 м ³		
Material	Laminated chipboard + stainless steel + tabletop coated with granite		
Dimensions (LxWxH), mm	1511x910x940		
Weight, kg	146		
Dealer Price (EXW), \$	664,6	820,8	763,8

Fast-food

Doner Kebab Vertical Grill Machine, electric SHSHE-2

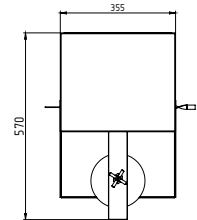
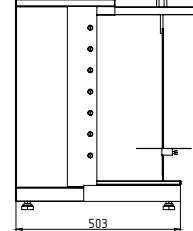
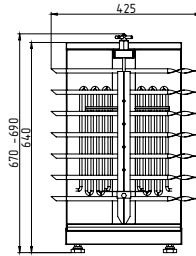

Description:

The machine is made of stainless steel AISI 430. Intended for Shawarma and kebab. One spit for Shawarma and 7 skewers. Manual spit rotation. Packing is stretch film.

Character description	SHSHE-2	SHSHE-2-N304	SHSHE-2-N430
Body frame material	AISI430/galv. steel	AISI 304	AISI 430
Number of heaters (pcs.)	2		
Number of skewers (pcs.)	7		
Rated capacity, kW	3,0		
Rated voltage, V	220B		
Dimensions (LxWxH), mm	425x503x670-690		
Weight, kg	15		
Dealer Price (EXW), \$	202,9	218,9	202,9

Deep frying machine for meat pastry (Chiburekki) AZHCHP-1

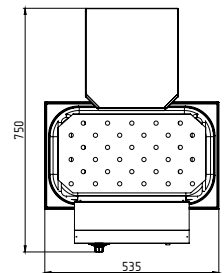
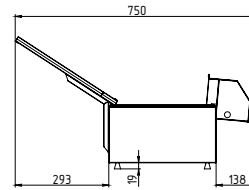
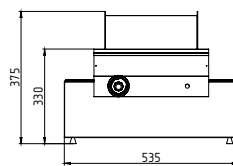

Description:

The machine is made of stainless steel AISI 430. Intended for deep frying of various food: minced pies, meat pastry, meat, fish, vegetables, etc. The tubular heater is protected with a grid. Heating temperature is from 0 to 300°C. Finished food is placed on a special tray to drain the excess oil. The oil is poured into a detachable gastronorm pan. Packing is stretch film.

Character description	AZHCHP-1	AZHCHP-1-N304	AZHCHP-1-N430
Body frame material	AISI430/galv. steel	AISI 304	AISI 430
Oil temperature under operation, C"	200±10		
Time of oil heating to operational condition (min.)	20		
Frying period, min.	3		
Oil filling volume, L	7		
Rated voltage, V	3		
Номинальное напряжение, В	220B		
Dimensions (LxWxH), mm	535x750x375		
Weight, kg	12		
Dealer Price (EXW), \$	174,4	182,4	174,4



Deep frying machine for doughnuts APZHP-1

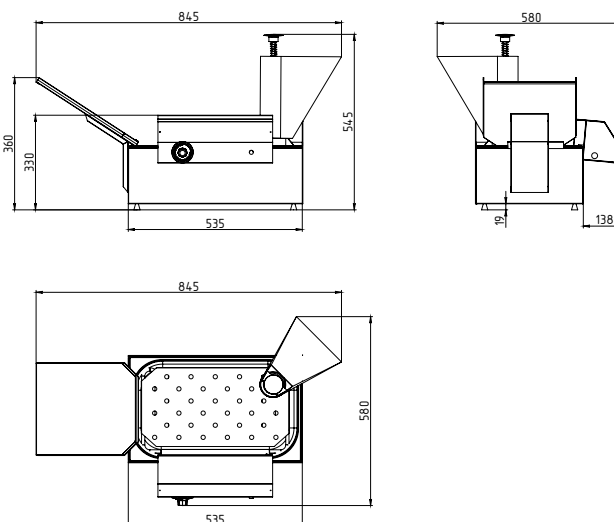

Description:

The machine is made of stainless steel AISI 430. The oil is poured into a detachable gastronorm pan. Equipped with a tray for oil drain from finished products and with a dough dispenser. Heating temperature is from 0 to 300°C. Packing is stretch film.

Character description	APZHP-1	APZHP-1-N304	APZHP-1-N430
Body frame material	AISI430/galv. steel	AISI 304	AISI 430
Oil temperature under operation, C°		200	
Time of oil heating to operational condition (min.)		20	
Frying period, min.		3	
Total volume of frying tub (L)		20	
Oil filling volume, L		7	
Rated capacity, kW		3	
Rated voltage, V		220B	
Dimensions (LxWxH), mm		845x580x545	
Weight, kg		17,5	
Dealer Price (EXW), \$	222,3	232,6	223,4



Electromechanical Equipment

Flour sifting machine, vibratory

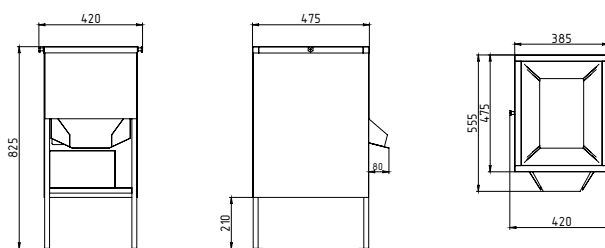

Description:

The flour sifting machine is intended for mechanization of the process of flour separation from foreign matter, as well as for flour loosening and aeration (equipped with scrap metal separator). Equipped with legs adjustable by height. The product is supplied assembled on a pallet. Packaging is stretch film.

Character description	MPV-150	MPV-150-N304	MPV-150-N430
Body frame material	AISI430/galv. steel	AISI 304	AISI 430
Capacity, kg/h, at least		150	
Rated supply voltage, V		380B	
Rated capacity, kW, not more		0,55	
Feed hopper capacity, kg, at least		20	
Noise level in operational mode, dB, not more		80	
Dimensions (LxWxH), mm		420x555x825	
Weight, kg		35	
Dealer Price (EXW), \$	346,6	426,4	386,5

Dough sheeter MRT-1

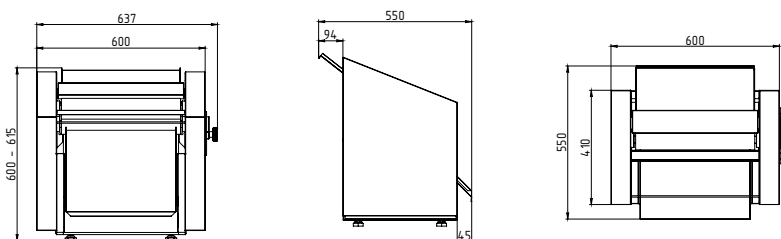

Description:

The machine is intended for sheeting tough scalded dough for cooking meat pastry, noodles, meat dumplings. It can be used for puff-paste cooking with light margarine. The product is supplied assembled on a pallet. Packaging is stretch film.

Character description	MRT-1	MRT-1-N304	MRT-1-N430
Body frame material	AISI430/galv. steel	AISI 304	AISI 430
Capacity, kg/h		35	
Dough sheet thickness, mm		1-4	
Max.width of sheeted dough strip, mm		400	
Rated voltage, V		380	
Rated capacity, kW		0,55	
Current, A, Hz		50	
Dimensions (LxWxH), mm		637x550x600	
Weight, kg, not more		50	
Dealer Price (EXW), \$	793,4	950,8	938,2

Preparation tables

Depending on type and thickness of the tabletop steel and framework material, industrial tables are produced in three series: ECONOM, STANDARD, PROFI. Tables of all series are produced in two variants: island type (without a border) and wall-mounted type (with a border).

Preparation table Series ECONOM

Preparation table SRO (without border)

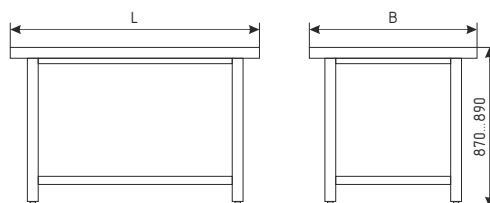

Preparation table SROb (with border)

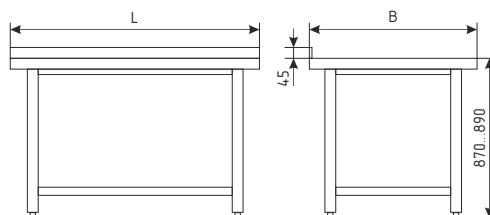

Description:

The tabletop is made of stainless steel of grade AISI 430, 0.5 mm thick and additionally strengthened with the laminated chipboard at least 16 mm thick. The table frame is made of galvanized (ECK-series) or stainless (ENK-series) steel angle. The tables are equipped with lattice shelves or optionally with blank shelves of galvanized or stainless steel which are mounted above the lattice shelf. The legs are fitted with screw-type supports enabling table height adjustment from 870 to 890 mm. The product is supplied disassembled. Packing is corrugated board.

Length L, mm	Width B, mm	Height mm	Tabletop AISI 430 0.5mm							
			Frame: angle (galvanized steel), lattice shelf				Frame: angle (galvanized steel), lattice shelf			
			without border	Dealer Price (EXW), \$	with border	Dealer Price (EXW), \$	without border	Dealer Price (EXW), \$	with border	Dealer Price (EXW), \$
600	600	870-890	SRO-6/6ECK	28,5	SROb-6/6ECK	29,6	SRO-6/6ENK	43,3	SROb-6/6ENK	45,6
800			SRO-8/6ECK	35,3	SROb-8/6ECK	37,6	SRO-8/6ENK	54,7	SROb-8/6ENK	58,1
900			SRO-9/6ECK	35,3	SROb-9/6ECK	37,6	SRO-9/6ENK	57	SROb-9/6ENK	60,4
1 000			SRO-10/6ECK	41	SROb-10/6ECK	43,3	SRO-10/6ENK	59,3	SROb-10/6ENK	61,6
1 200			SRO-12/6ECK	46,7	SROb-12/6ECK	50,2	SRO-12/6ENK	69,5	SROb-12/6ENK	71,8
1 500			SRO-15/6ECK	50,2	SROb-15/6ECK	53,6	SRO-15/6ENK	76,4	SROb-15/6ENK	79,8
1 800	SRO-18/6ECK		62,7	SROb-18/6ECK	66,1	SRO-18/6ENK	99,2	SROb-18/6ENK	102,6	
900	700		SRO-9/7ECK	52,4	SROb-9/7ECK	54,7	SRO-9/7ENK	67,3	SROb-9/7ENK	70,7
1 000			SRO-10/7ECK	55,9	SROb-10/7ECK	58,1	SRO-10/7ENK	69,5	SROb-10/7ENK	71,8
1 200			SRO-12/7ECK	59,3	SROb-12/7ECK	61,6	SRO-12/7ENK	74,1	SROb-12/7ENK	76,4
1 500			SRO-15/7ECK	67,3	SROb-15/7ECK	70,7	SRO-15/7ENK	83,2	SROb-15/7ENK	85,5
1 800			SRO-18/7ECK	77,5	SROb-18/7ECK	80,9	SRO-18/7ENK	98	SROb-18/7ENK	100,3



Preparation table Series STANDARD

Preparation table SRO (without border)

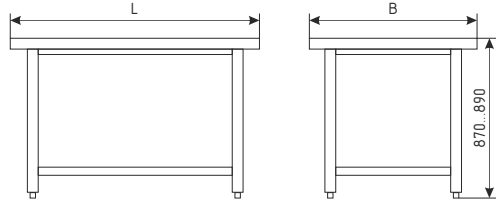

Preparation table SROb (with border)

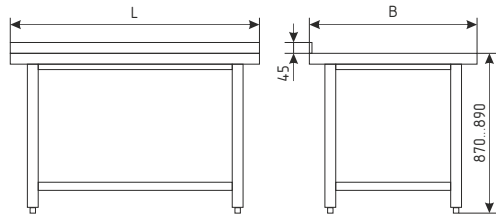

Description:

The tabletop is made of stainless steel of grade AISI 430 or AISI 304 0.8 mm thick and is additionally strengthened with the laminated chipboard at least 16 mm thick. The table frame is made of galvanized (SCK-series) or stainless (SNK-series, NK-series) steel angle. The tables are equipped with lattice shelves or optionally with blank shelves of galvanized or stainless steel which are mounted above the lattice shelf. The legs are fitted with screw-type supports enabling table height adjustment from 870 to 890 mm. The product is supplied disassembled. Packing is corrugated board.

Length L, mm	Width B, mm	Height, mm	Tabletop AISI 430 0.8 mm						Tabletop: AISI 304 0.8 mm					
			Frame: angle (galvanized steel), lattice shelf				Frame: angle (stainless steel AISI 430), lattice shelf				Frame: angle (stainless steel AISI 304), lattice shelf			
			w/o border	Dealer Price (EXW), \$	with border	Dealer Price (EXW), \$	w/o border	Dealer Price (EXW), \$	with border	Dealer Price (EXW), \$	w/o border	Dealer Price (EXW), \$	with border	Dealer Price (EXW), \$
600	600	870-890	SRO-6/6SCK	31,9	SROb-6/6SCK	34,2	SRO-6/6SNK	44,5	SROb-6/6SNK	47,9	SRO-6/6S304NK	84,4	SROb-6/6S304NK	87,8
800			SRO-8/6SCK	38,8	SROb-8/6SCK	42,2	SRO-8/6SNK	58,1	SROb-8/6SNK	60,4	SRO-8/6S304NK	88,9	SROb-8/6S304NK	92,3
900			SRO-9/6SCK	42,2	SROb-9/6SCK	44,5	SRO-9/6SNK	60,4	SROb-9/6SNK	65	SRO-9/6S304NK	85,5	SROb-9/6S304NK	87,8
1 000			SRO-10/6SCK	43,3	SROb-10/6SCK	47,9	SRO-10/6SNK	62,7	SROb-10/6SNK	67,3	SRO-10/6S304NK	98	SROb-10/6S304NK	101,5
1 200			SRO-12/6SCK	49	SROb-12/6SCK	52,4	SRO-12/6SNK	70,7	SROb-12/6SNK	74,1	SRO-12/6S304NK	101,5	SROb-12/6S304NK	104,9
1 500			SRO-15/6SCK	60,4	SROb-15/6SCK	63,8	SRO-15/6SNK	80,9	SROb-15/6SNK	84,4	SRO-15/6S304NK	117,4	SROb-15/6S304NK	120,8
1 800	700	870-890	SRO-18/6SCK	75,2	SROb-18/6SCK	80,9	SRO-18/6SNK	104,9	SROb-18/6SNK	109,4	SRO-18/6S304NK	114	SROb-18/6S304NK	118,6
900			SRO-9/7SCK	53,6	SROb-9/7SCK	55,9	SRO-9/7SNK	70,7	SROb-9/7SNK	75,2	SRO-9/7S304NK	95,8	SROb-9/7S304NK	99,2
1 000			SRO-10/7SCK	55,9	SROb-10/7SCK	58,1	SRO-10/7SNK	73	SROb-10/7SNK	77,5	SRO-10/7S304NK	100,3	SROb-10/7S304NK	103,7
1 200			SRO-12/7SCK	62,7	SROb-12/7SCK	65	SRO-12/7SNK	83,2	SROb-12/7SNK	86,6	SRO-12/7S304NK	104,9	SROb-12/7S304NK	108,3
1 500			SRO-15/7SCK	74,1	SROb-15/7SCK	76,4	SRO-15/7SNK	101,5	SROb-15/7SNK	106	SRO-15/7S304NK	123,1	SROb-15/7S304NK	125,4
1 800			SRO-18/7SCK	95,8	SROb-18/7SCK	100,3	SRO-18/7SNK	115,1	SROb-18/7SNK	119,7	SRO-18/7S304NK	128,8	SROb-18/7S304NK	133,4



Plain shelf for preparation table of ECONOM & STANDARD Series - OPTIONAL

The plain shelf can be additionally purchased for tables with a lattice shelf that can be independently mounted above the lattice shelf.



Plain shelf

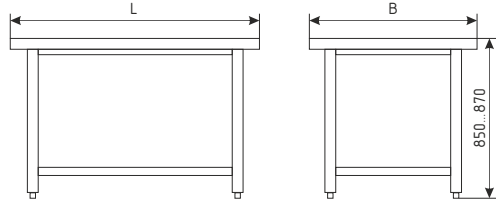

Table dimensions, mm		Galvanized steel, 0.8 mm	Dealer Price (EXW), \$	Stainless steel AISI 430, 0.8 mm	Dealer Price (EXW), \$
Length, L	Width, B				
600	600	PC-6/6	3,4	PN-6/6	9,1
800		PC-8/6	3,4	PN-8/6	9,1
900		PC-9/6	3,4	PN-9/6	10,3
1000		PC-10/6	4,6	PN-10/6	11,4
1200		PC-12/6	4,6	PN-12/6	13,7
1500		PC-15/6	5,7	PN-15/6	17,1
1800		PC-18/6	6,8	PN-18/6	20,5
600		700	PC-6/7	3,4	PN-6/7
800	PC-8/7		4,6	PN-8/7	11,4
900	PC-9/7		4,6	PN-9/7	12,5
1000	PC-10/7		4,6	PN-10/7	13,7
1200	PC-12/7		5,7	PN-12/7	16
1500	PC-15/7		6,8	PN-15/7	20,5
1800	PC-18/7		8	PN-18/7	23,9



Preparation table Series PROFI

Preparation table SRO (without border)



Preparation table SROb (with border)

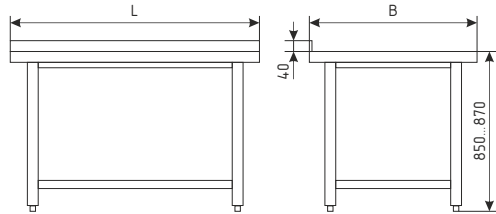

Description:

Made of stainless steel of grade AISI 430 or AISI 304 0.8 mm thickness and is additionally strengthened with the laminated chipboard at least 16 mm thickness. The table frame is strengthened and made of pipe (square section 40x40 mm). The tables are equipped with blank shelves of steel. The legs are fitted with screw-type supports enabling table height adjustment from 850 to 870 mm. The product is supplied disassembled. Packing is corrugated board.

Length L, mm	Width B, mm	Height, mm	Tabletop AISI 430 0.8mm				Tabletop AISI 304 0.8mm			
			Frame: pipe 40x40 from stainless steel AISI 430				Frame: pipe 40x40 from stainless steel AISI 304			
			w/o border	Dealer Price (EXW), \$	with border	Dealer Price (EXW), \$	w/o border	Dealer Price (EXW), \$	with border	Dealer Price (EXW), \$
800	600	850-870	SRO-8/6PNT	98	SROb-8/6PNT	101,5	SRO-8/6P304NT	111,7	SROb-8/6P304NT	115,1
900			SRO-9/6PNT	103,7	SROb-9/6PNT	108,3	SRO-9/6P304NT	125,4	SROb-9/6P304NT	120,8
1 000			SRO-10/6PNT	110,6	SROb-10/6PNT	114	SRO-10/6P304NT	128,8	SROb-10/6P304NT	133,4
1 200			SRO-12/6PNT	118,6	SROb-12/6PNT	122	SRO-12/6P304NT	140,2	SROb-12/6P304NT	143,6
1 500			SRO-15/6PNT	130	SROb-15/6PNT	133,4	SRO-15/6P304NT	150,5	SROb-15/6P304NT	152,8
1 800			SRO-18/6PNT	152,8	SROb-18/6PNT	159,6	SRO-18/6P304NT	179	SROb-18/6P304NT	184,7
900	700		SRO-9/7PNT	108,3	SROb-9/7PNT	111,7	SRO-9/7P304NT	125,4	SROb-9/7P304NT	130
1 000			SRO-10/7PNT	116,3	SROb-10/7PNT	119,7	SRO-10/7P304NT	137,9	SROb-10/7P304NT	141,4
1 200			SRO-12/7PNT	125,4	SROb-12/7PNT	128,8	SRO-12/7P304NT	147,1	SROb-12/7P304NT	150,5
1 500			SRO-15/7PNT	137,9	SROb-15/7PNT	141,4	SRO-15/7P304NT	164,2	SROb-15/7P304NT	167,6
1 800			SRO-18/7PNT	165,3	SROb-18/7PNT	172,1	SRO-18/7P304NT	191,5	SROb-18/7P304NT	197,2



TABLES FOR COLLECTING FOOD RESIDUALS

Table for collecting food residuals SSOP

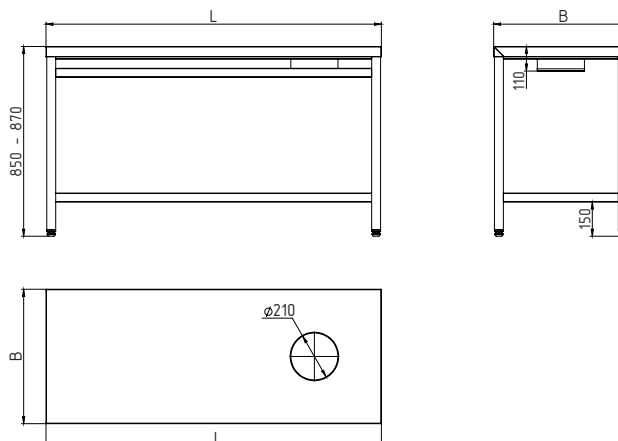

Description:

The table is intended for waste collecting in production premises of public catering facilities. The tabletop is stainless steel AISI 430 0,5 mm. The tabletop can be mounted both with left and with right arrangement of the hole. The frame is painted, demountable, of mild steel pipe 40x40 mm. The legs are fitted with screw-type support enabling table height adjustment from 850 to 870 mm. The product is supplied disassembled. Packing is corrugated board.

Item code	Length L, mm	Width B, mm	Height, mm	Dealer Price (EXW), \$
SSOP-6/6ENP	600	600	850-870	41
SSOPI-10/6ENP	1000			51,3
SSOPI-12/6ENP	1200			57
SSOPI-15/6ENP	1500			68,4
SSOPp-10/6ENP	1000			51,3
SSOPp-12/6ENP	1200			57
SSOPp-15/6ENP	1500			68,4

CONFECTIONERY TABLE

Confectionery table

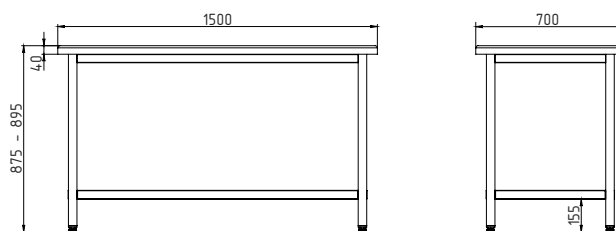

Description:

The table is intended for use at public catering facilities for performance of works related to preparation of cookery and flour products. The tabletop is made of solid beechwood 40 mm thickness. The frame is demountable, of mild steel pipe 40x40 mm, painted. The legs are fitted with screw-type supports enabling table height adjustment from 875 to 895 mm. The product is supplied disassembled. Packing is corrugated board.

Item code	Length L, mm	Width B, mm	Height M, mm	Dealer Price (EXW), \$
SROk-9/7	900	700	875-895	117,4
SROk-15/7	1500			190,4



Washing sinks

Washing sinks are produced with two types of washing capacities: welded capacity and capacity solid-drawn. The solid-drawn capacity has no welded seams, and it considerably facilitates hygienic sink cleaning.

Depending on the type and thickness of steel the washing capacity is made of, washing sinks are produced in three Series: ECONOM, STANDARD, and PROFI. Sinks of ECONOM and STANDARD series are produced with the washing capacity of the welded type, and are not equipped with the wall-mounted border, the sinks of PROFI series are produced only with the solid-drawn washing capacity, can be equipped with the wall-mounted border, have the strengthened frame and the proper site for water faucet installation.

ECONOM Series

VMO1 (1 section)

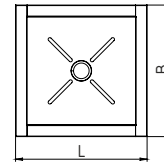
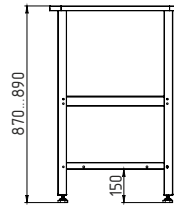

VMO2 (2 sections)

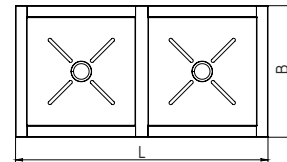
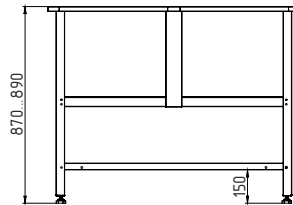

VMO3 (3 sections)

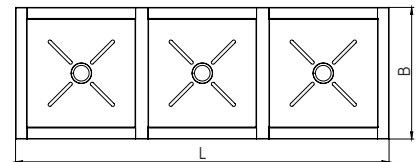
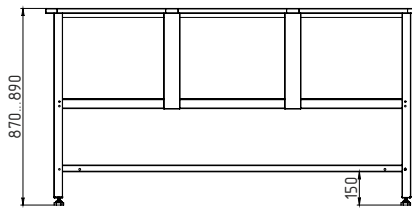

Description:

The welded washing capacity is made of stainless steel grade AISI 430 0.5 – 0.6 mm thickness with the hole 52 mm in diameter for siphon drain installation. The sink frame is made of galvanized or stainless steel angle. The legs are fitted with screw-type supports enabling sink height adjustment from 870 to 890 mm. The sink is equipped with the lattice shelf. The product is supplied disassembled. Packing is corrugated board.

Number of sections	Dimensions, mm			Washing capacity size, mm			Washing capacity material AISI 430 0.5-0.6 mm			
	Length, L	Width, B	Height	Length	Width	Height	Frame: angle (galvanized steel)		Frame: angle (stainless steel)	
							without border	Dealer Price (EXW), \$	without border	Dealer Price (EXW), \$
1 section	530	530	870-890	430	430	300	VMO1-430ECK-M	44,5	VMO1-430ENK-M	60,4
	580	580		480	480	400	VMO1-480ECK-M	51,3	VMO1-480ENK-M	69,5
	630	630		530	530	400	VMO1-530ECK-M	59,3	VMO1-530ENK-M	77,5
	730	730		630	630	400	VMO1-630ECK-M	73	VMO1-630ENK-M	91,2
	800	800		700	700	400	VMO1-700ECK-M	84,4	VMO1-700ENK-M	101,5
2 sections	1020	530		430	430	300	VMO2-430ECK-M	76,4	VMO2-430ENK-M	100,3
	1120	580		480	480	400	VMO2-480ECK-M	93,5	VMO2-480ENK-M	115,1
	1220	630		530	530	400	VMO2-530ECK-M	103,7	VMO2-530ENK-M	124,3
	1420	730		630	630	400	VMO2-630ECK-M	123,1	VMO2-630ENK-M	141,4
	1560	800		700	700	400	VMO2-700ECK-M	159,6	VMO2-700ENK-M	173,3
3 sections	1500	530		430	430	300	VMO3-430ECK-M	102,6	VMO3-430ENK-M	131,1
	1650	580	480	480	400	VMO3-480ECK-M	120,8	VMO3-480ENK-M	164,2	
	1800	630	530	530	400	VMO3-530ECK-M	133,4	VMO3-530ENK-M	177,8	
	2100	730	630	630	400	VMO3-630ECK-M	189,2	VMO3-630ENK-M	210,9	
	2310	800	700	700	400	VMO3-700ECK-M	218,9	VMO3-700ENK-M	244	



STANDARD Series

VMO1 (1 section)

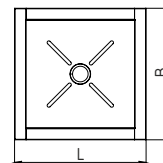
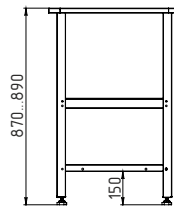

VMO2 (2 sections)

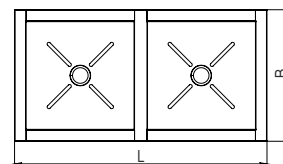
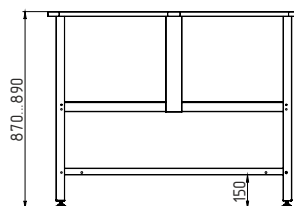

VMO2 (3 sections)

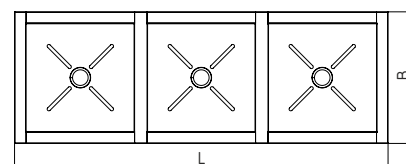
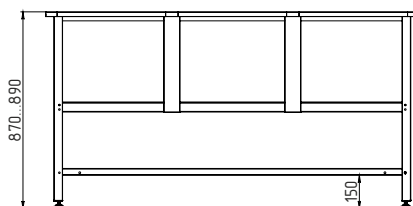

Description:

The welded washing capacity is made of stainless steel grades AISI 430 or AISI 304 0.8 mm thickness with the hole 52 mm in diameter for siphon drain installation. The sink frame is made of galvanized or stainless steel angle. The legs are fitted with screw-type supports enabling sink height adjustment from 870 to 890 mm. The sink is equipped with the lattice shelf. The product is supplied disassembled. Packing is corrugated board.

Number of sections	Dimensions, mm			Washing capacity size, mm			Washing capacity material AISI 430 0,8 mm				Capacity material AISI 304 0,8 mm	
							Frame: angle (galvanized steel)		Frame: angle (stainless steel AISI 430)			
	Length L	Width, B	Height	Length	Width	Height	without border	Dealer Price (EXW), \$	without border	Dealer Price (EXW), \$	without border	Dealer Price (EXW), \$
1 section	530	530	870-890	430	430	300	VMO1-430SCK-M	45,6	VMO1-430SNK-M	68,4	VMO1-430S304NK	83,2
	580	580		480	480	400	VMO1-480SCK-M	53,6	VMO1-480SNK-M	76,4	VMO1-480S304NK	100,3
	630	630		530	530	400	VMO1-530SCK-M	61,6	VMO1-530SNK-M	87,8	VMO1-530S304NK	117,4
	730	730		630	630	400	VMO1-630SCK-M	71,8	VMO1-630SNK-M	102,6	VMO1-630S304NK	134,5
	800	800		700	700	400	VMO1-700SCK-M	84,4	VMO1-700SNK-M	111,7	VMO1-700S304NK	148,2
2 sections	1020	530	430	430	300	VMO2-430SCK-M	82,1	VMO2-430SNK-M	106	VMO2-430S304NK	143,6	
	1120	580	480	480	400	VMO2-480SCK-M	101,5	VMO2-480SNK-M	130	VMO2-480S304NK	167,6	
	1220	630	530	530	400	VMO2-530SCK-M	110,6	VMO2-530SNK-M	141,4	VMO2-530S304NK	187	
	1420	730	630	630	400	VMO2-630SCK-M	132,2	VMO2-630SNK-M	165,3	VMO2-630S304NK	201,8	
	1560	800	700	700	400	VMO2-700SCK-M	168,7	VMO2-700SNK-M	188,1	VMO2-700S304NK	241,7	
3 sections	1500	530	430	430	300	VMO3-430SCK-M	116,3	VMO3-430SNK-M	149,3	VMO3-430S304NK	189,2	
	1650	580	480	480	400	VMO3-450SCK-M	147,1	VMO3-450SNK-M	175,6	VMO3-450S304NK	223,4	
	1800	630	530	530	400	VMO3-530SCK-M	158,5	VMO3-530SNK-M	206,3	VMO3-530S304NK	246,2	
	2100	730	630	630	400	VMO3-630SCK-M	183,5	VMO3-630SNK-M	239,4	VMO3-630S304NK	247,4	
	2310	800	700	700	400	VMO3-700SCK-M	210,9	VMO3-700SNK-M	270,2	VMO3-700S304NK	330,6	



Washing sinks - solid-drawn washing capacity

PROFI series

VMOc1 (1 section)

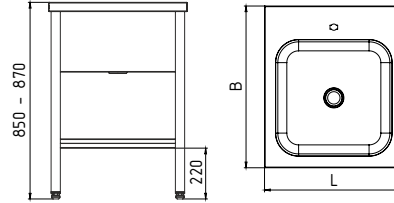

VMOc2 (2 sections)

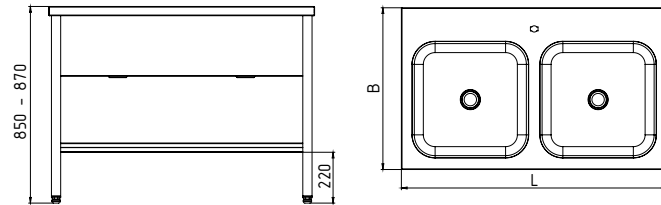

VMOc3 (3 sections)

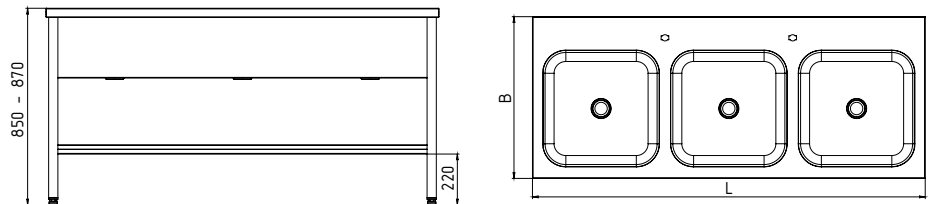

Description:

The solid-drawn washing capacity is made of stainless steel grade AISI 304 1.0 mm thickness. The frame is made of stainless steel grade AISI 304. There is a hole 52 mm in diameter for siphon drain installation. The tabletop is equipped with the proper site for water faucet installation. The sink can be fitted with the wall-mounted border. The frame is made of pipe (square section, 40x40 mm). The legs are fitted with screw-type supports enabling sink height adjustment from 850 to 870 mm. The product is supplied disassembled. Packing is corrugated board.

Number of sections	Dimensions, mm			Washing capacity size, mm			Stainless steel AISI 304 1.0 mm			
							Frame: pipe 40x40 steel AISI 304			
	Length, L	Width, B	Height	Length	Width	Height	without shelf			
w/o border							Dealer Price (EXW), \$	border	Dealer Price (EXW), \$	
1 section	550	600	850-870	450	450	300	VMOc1-450PNT	145,9	VMOc1-450PNT	158,5
	600	700	850-870	500	500	300	VMOc1-500PNT	174,4	VMOc1-500PNT	189,2
	700	700	850-870	600	500	300	VMOc1-600PNT	191,5	VMOc1-600PNT	213,2
2 sections	1050	600	850-870	450	450	300	VMOc2-450PNT	229,1	VMOc2-450PNT	233,7
	1150	700	850-870	500	500	300	VMOc2-500PNT	302,1	VMOc2-500PNT	308,9
	1350	700	850-870	600	500	300	VMOc2-600PNT	310,1	VMOc2-600PNT	346,6
3 sections	1550	600	850-870	450	450	300	VMOc3-450PNT	332,9	VMOc3-450PNT	335,2
	1700	700	850-870	500	500	300	VMOc3-500PNT	400,1	VMOc3-500PNT	444,6
	2000	700	850-870	600	500	300	VMOc3-600PNT	450,3	VMOc3-600PNT	453,7



Washing sinks with the work space - welded washing capacity

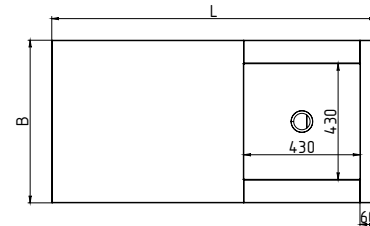
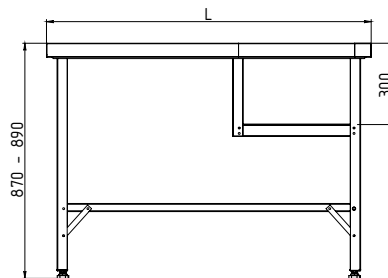

Description:

The welded washing capacity is made of stainless steel grades AISI 430 or AISI 304 0.8 mm thickness. There is the hole 52 mm in diameter for siphon drain installation. The tabletop is made of stainless steel of grade AISI 430, 0.8 mm thickness and is additionally strengthened with the laminated chipboard at least 16 mm thickness. The table frame is made of galvanized steel angle. The legs are fitted with screw-type supports enabling table height adjustment from 870 to 890 mm. The product is supplied disassembled. Packing is corrugated board.

Number of sections	Table size			Washing capacity size, mm			Washing capacity material AISI 430 0,8 mm	Dealer Price (EXW), \$
							Frame: angle (galvanized steel)	
	Length, L, mm	Width, B, mm	Height	Length	Width	Height	Lattice shelf without border	
1 section	1200	600	870-890	430	430	300	SRO12/6SCK+VMO1-430	110,6
	1500						SRO15/6SCK+VMO1-430	127,7

Washing sink extruded with the work space SRO+VMOc

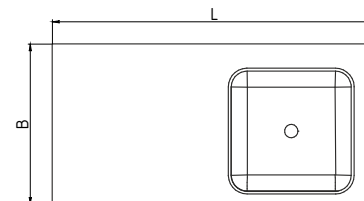
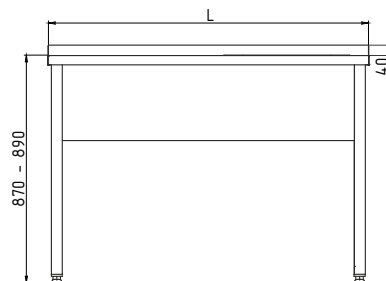

Description:

Table top, front, rear and side rail are made of stainless steel AISI 430, 0.8 mm thickness. Washing sink is made of stainless steel AISI 304, 0.8 mm thickness. Table top is additionally strengthened with laminated chipboard, 16 mm thickness. The table frame is made of stainless steel tube 40x40 mm. The legs are fitted with screw-type supports enabling sink height adjustment from 870 to 890 mm. Products supplied disassembled, packing is corrugated board.

Number of sections	Table size			Washing capacity size, mm			Washing capacity material AISI 304 0,8 mm	Dealer Price (EXW), \$
							Frame: pipe (stainless steel 40x40 mm, AISI 304)	
	Length, L, mm	Width, B, mm	Height	Length	Width	Height	without lattice shelf	
1 section	1200	600	870-890	450	450	300	SRO12/6PNT+VMOc1-450L	141,4
	1500						SRO15/6PNT+VMOc1-450L	159,6
	1200	700		500	500	300	SRO12/7PNT+VMOc1-500L	173,3
	1500						SRO15/7PNT+VMOc1-500L	185,8
1 section	1200	600	870-890	450	450	300	SRO12/6PNT+VMOc1-450P	141,4
	1500						SRO15/6PNT+VMOc1-450P	159,6
	1200	700		500	500	300	SRO12/7ПНТ+ВМОц1-500П	173,3
	1500						SRO15/7ПНТ+ВМОц1-500П	185,8



Washing sinks: pan washing sink - welded washing capacity

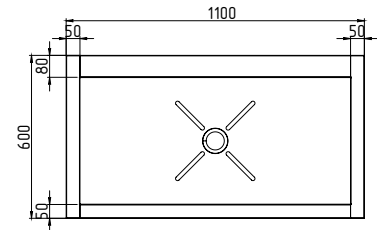
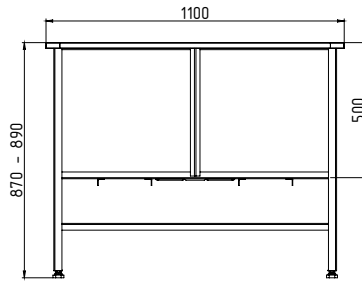

Description:

The welded washing capacity is made of stainless steel grades AISI 430 0.8 mm thickness. There is the hole 52 mm in diameter for siphon drain installation. The table frame is made of painted mild steel angle. The legs are fitted with screw-type supports enabling table height adjustment from 870 to 890 mm. The sink is equipped with the lattice shelf. The product is supplied disassembled. Packing is corrugated board.

Number of sections	Table size, mm			Washing capacity size, mm			Washing capacity material AISI 430 0.8 mm	Dealer Price (EXW), \$
	Length	Width	Height	Length	Width	Height	Frame: angle (painted steel)	
							without border	
1 section	1100	600	870-890	1000	470	500	VMO-1	164,2



KITCHEN RACKS

Kitchen racks depending on the frame type are produced in three Series: ECONOM, STANDARD, and PROFIL.

Kitchen Rack SKK Series ECONOM

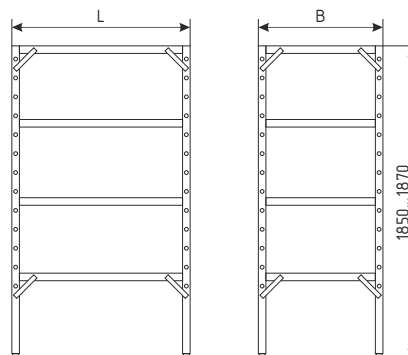

Description:

The frame is made of galvanized steel angle. The shelves are made of stainless steel grade AISI 430 depending on products series, available thickness is 0.5 or 0.8 mm. Rack posts have fastener holes for shelf installation at any height needed. The rack has legs adjustable by height. The product is supplied disassembled. Packing is corrugated board.

Kitchen Rack SKN Series STANDARD

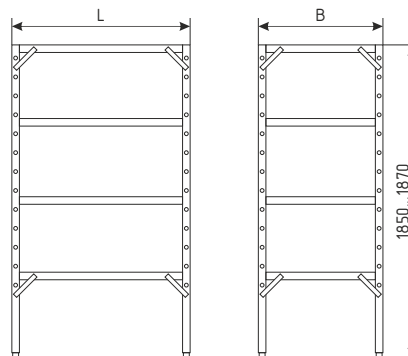

Description:

The frame is made of stainless steel angle. The shelves are made of stainless steel grade AISI 430 depending on products series, available thickness is 0.5 or 0.8 mm. Rack posts have fastener holes for shelf installation at any height needed. The rack has legs adjustable by height. The product is supplied disassembled. Packing is corrugated board.

Length L, mm	Width B, mm	Height, mm	ECONOM, shelf-0.5 mm		ECONOM, shelf-0.8 mm		STANDARD, shelf-0,5 mm		STANDARD, shelf-0,8 mm	
			Frame: angle (galvanized steel)	Price, \$	Frame: angle (galvanized steel)	Dealer Price (EXW), \$	Frame: angle (stainless steel)	Dealer Price (EXW), \$	Frame: angle (stainless steel)	Dealer Price (EXW), \$
700	400	1850 - 1870	SKK-7/4S4E-0,5	52,4	SKK-7/4S4E	60,4	SKN-7/4S4S-0,5	65	SKN-7/4S4S	74,1
800			SKK-8/4S4E-0,5	55,9	SKK-8/4S4E	62,7	SKN-8/4S4S-0,5	75,2	SKN-8/4S4S	85,5
900			SKK-9/4S4E-0,5	62,7	SKK-9/4S4E	71,8	SKN-9/4S4S-0,5	79,8	SKN-9/4S4S	90,1
1000			SKK-10/4S4E-0,5	68,4	SKK-10/4S4E	77,5	SKN-10/4S4S-0,5	99,2	SKN-10/4S4S	95,8
1200			SKK-12/4S4E-0,5	77,5	SKK-12/4S4E	87,8	SKN-12/4S4S-0,5	98	SKN-12/4S4S	111,7
1400			SKK-14/4S4E-0,5	87,8	SKK-14/4S4E	99,2	SKN-14/4S4S-0,5	102,6	SKN-14/4S4S	117,4
700	500		SKK-7/5S4E-0,5	69,5	SKK-7/5S4E	78,7	SKN-7/5S4S-0,5	84,4	SKN-7/5S4S	99,2
800			SKK-8/5S4E-0,5	69,5	SKK-8/5S4E	78,7	SKN-8/5S4S-0,5	86,6	SKN-8/5S4S	99,2
900			SKK-9/5S4E-0,5	71,8	SKK-9/5S4E	80,9	SKN-9/5S4S-0,5	90,1	SKN-9/5S4S	102,6
1000			SKK-10/5S4E-0,5	73	SKK-10/5S4E	85,5	SKN-10/5S4S-0,5	101,5	SKN-10/5S4S	115,1
1200			SKK-12/5S4E-0,5	84,4	SKK-12/5S4E	96,9	SKN-12/5S4S-0,5	103,7	SKN-12/5S4S	118,6
1400			SKK-14/5S4E-0,5	98	SKK-14/5S4E	115,1	SKN-14/5S4S-0,5	125,4	SKN-14/5S4S	142,5
700	600		SKK-7/6S4E-0,5	73	SKK-7/6S4E	82,1	SKN-7/6S4S-0,5	93,5	SKN-7/6S4S	115,1
800			SKK-8/6S4E-0,5	75,2	SKK-8/6S4E	85,5	SKN-8/6S4S-0,5	95,8	SKN-8/6S4S	108,3
900			SKK-9/6S4E-0,5	78,7	SKK-9/6S4E	88,9	SKN-9/6S4S-0,5	99,2	SKN-9/6S4S	112,9
1000			SKK-10/6S4E-0,5	82,1	SKK-10/6S4E	93,5	SKN-10/6S4S-0,5	108,3	SKN-10/6S4S	123,1
1200			SKK-12/6S4E-0,5	95,8	SKK-12/6S4E	108,3	SKN-12/6S4S-0,5	114	SKN-12/6S4S	130
1400			SKK-14/6S4E-0,5	112,9	SKK-14/6S4E	128,8	SKN-14/6S4S-0,5	132,2	SKN-14/6S4S	150,5



PROFI series

Kitchen Rack SKN Series PROFI

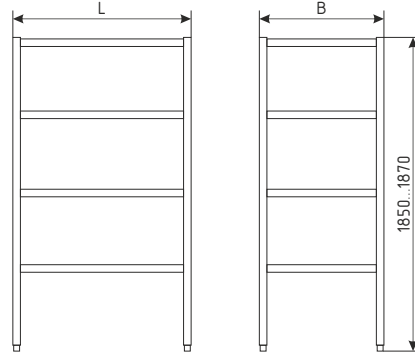

Description:

Rack is made entirely of stainless steel AISI304. The frame is made of stainless steel pipe (square section 40x40 mm). The rack has legs adjustable by height. The product is supplied disassembled. Packing is corrugated board

Length L, mm	Width B, mm	Height, mm	Series PROFI AISI 304		Dealer Price (EXW), \$
			Frame (pipe stainless 40x40 mm)		
1000	400	1850-1870	SKN-10/4S4P		107,2
	500		SKN-10/5S4P		111,7
	600		SKN-10/6S4P		123,1
1200	400		SKN-12/4S4P		119,7
	500		SKN-12/5S4P		127,7
	600		SKN-12/6S4P		141,4
1400	400		SKN-14/4S4P		131,1
	500		SKN-14/5S4P		148,2
	600		SKN-14/6S4P		157,3



Glass Drain Rack

The racks are used for draining of plates and glasses. According to installation type, can be divided into two types: floor and wall-mounted. Depending on the frame type, the drain racks are available in two series: ECONOM and STANDARD.

Glass Drain Rack wall-mounted, 2 shelves

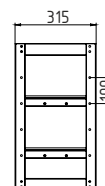
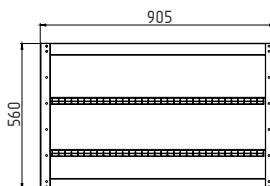

Glass Drain Rack wall-mounted, 3 shelves

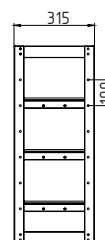
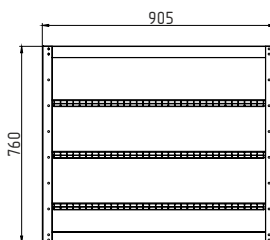

Glass Drain Rack floor-mounted, 5 shelves

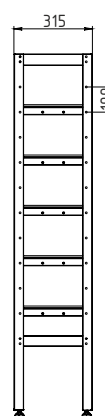
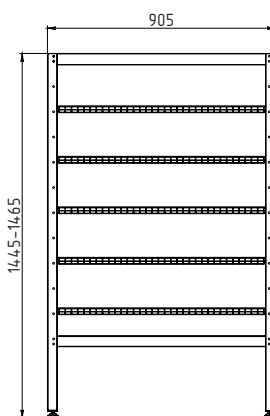

Description:

The frame is made of galvanized or stainless steel AISI 430 angle. The shelf is made of chrome-plated steel lattice. Under the bottom shelf, a stainless steel tray is mounted to collect liquid. The floor-mounted rack has legs adjustable by height. The product is supplied disassembled. Packing is corrugated board.

Rack type	Number of shelves	Series ECONOM	Dealer Price (EXW), \$	Series STANDARD	Dealer Price (EXW), \$	Dimensions (LxWxH), mm
		Frame: angle (galvanized steel)		Frame: angle (stainless steel AISI430)		
		Shelves: chrome-plated lattice		Shelves: chrome-plated lattice		
wall-mounted	2	SKSK-2KE-M	33,1	SKSN-2KS-M	67,3	905x315x560
	3	SKSK-3KE-M	45,6	SKSN-3KS-M	92,3	905x315x760
floor-mounted	5	SKSK-4KE-M	88,9	SKSN-4KS-M	141,4	905x315x1445



Dish Drain Rack

Dish Drain Rack wall-mounted, 2 shelves

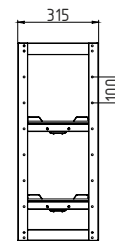
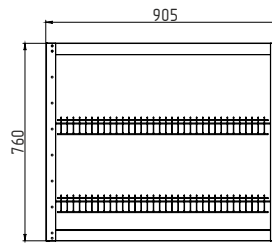

Dish Drain Rack wall-mounted, 3 shelves

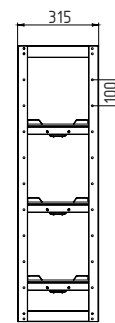
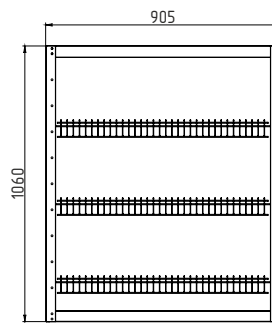

Dish Drain Rack floor-mounted, 4 shelves

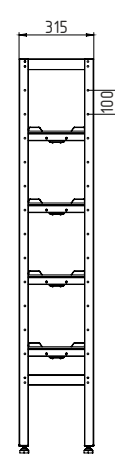
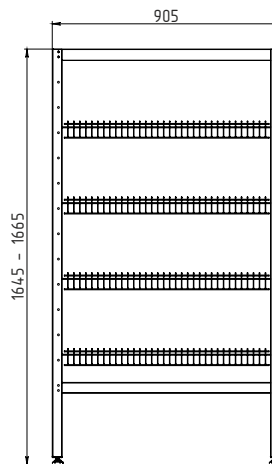

Description:

The frame is made of galvanized or stainless steel AISI 430 angle. The shelf is made of chrome-plated steel lattice. Under the bottom shelf, a stainless steel tray is mounted to collect liquid. The floor-mounted rack has legs adjustable by height. The product is supplied disassembled. Packing is corrugated board.

Rack type	Number of shelves	Capacity	Series ECONOM		Series STANDARD		Dimensions (LxWxH), mm
			Frame: angle (galvanized steel)	Dealer Price (EXW), \$	Frame: angle (stainless steel AISI430)	Dealer Price (EXW), \$	
			Shelves: chrome-plated lattice		Shelves: chrome-plated lattice		
wall-mounted	2	68	SKTK-2KE-M	33,1	SKTN-2KS-M	76,4	905x315x760
	3	102	SKTK-3KE-M	45,6	SKTN-3KS-M	93,5	905x315x1060
floor-mounted	4	136	SKTK-4KE-M	70,7	SKTN-4KS-M	127,7	905x315x1645



Dish Drain Rack

Dish Drain Rack wall-mounted, 2 shelves

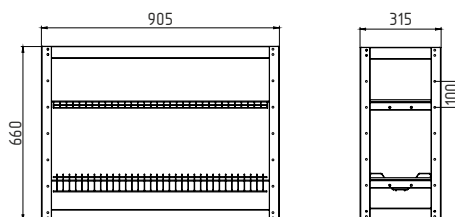

Dish Drain Rack wall-mounted, 3 shelves

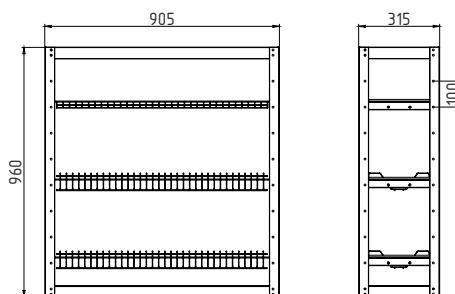

Dish Drain Rack floor-mounted, 5 shelves

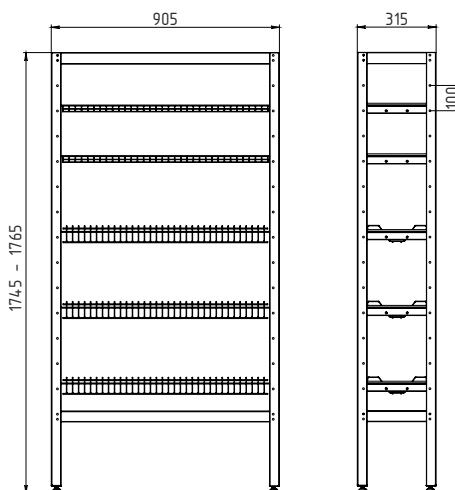

Description:

The frame is made of galvanized or stainless steel AISI 430 angle. The shelf is made of chrome-plated steel lattice. Under the bottom shelf, a stainless steel tray is mounted to collect liquid. The floor-mounted rack has legs adjustable by height. The product is supplied disassembled. Packing is corrugated board.

Rack type	Capacity		Series ECONOM		Series STANDARD		Dimensions (LxWxH), mm
			Frame: angle (galvanized steel)	Dealer Price (EXW), \$	Frame: angle (stainless steel AISI430)	Dealer Price (EXW), \$	
	plates	glasses	Shelves: chrome-plated lattice		Shelves: chrome-plated lattice		
wall-mounted	34	1 shelf	SKTSK-11KE-M	37,6	SKTSN-11KC-M	87,8	905x315x660
	68		SKTSK-21KE-M	58,1	SKTSN-21KC-M	111,7	905x315x960
floor-mounted	102	2 shelves	SKTSK-32KE-M	101,5	SKTSN-32KC-M	139,1	905x315x1745



Kitchen cabinets

Kitchen cabinet with sliding doors (SHKH-K-N)

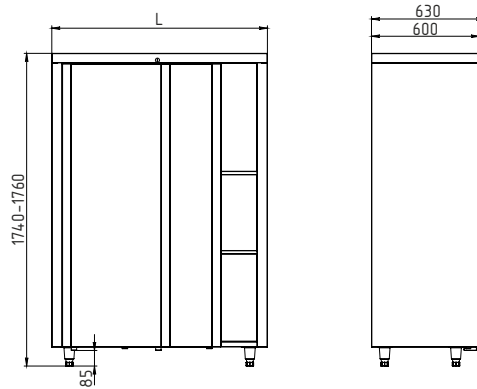

Description:

The kitchen cabinet with sliding doors is intended for storing kitchen utensils, equipment, and food products. The cabinet has two sliding doors and solid shelves. The cabinet is made of stainless steel AISI 430 and galvanized steel. It has legs adjustable by height. The product is supplied assembled.

Length, mm	Width, mm	Height, mm	Material: stainless steel+galvanized steel	Dealer Price (EXW), \$
600	1200	1740-1760	SHKH-K-N-1200	318,1
	1500		SHKH-K-N-1500	425,2

Kitchen cabinet with hinged doors SHKH-R-O-660 shelves

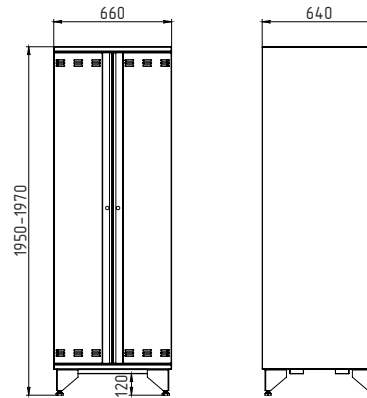

Description:

The kitchen cabinet with double hinged doors. Suitable for storing pastry, food products, and kitchen utensils. Each section comprises 5 stainless steel AISI 430 shelves. The cabinet is made of steel painted with grey resistant paint. It has legs adjustable by height. The product is supplied assembled. Packing is stretch wrap.

Length, mm	Width, mm	Height, mm	Material: painted steel	Dealer Price (EXW), \$
640	660	1950-1970	SHKH-R-O-660	282,7

Kitchen pastries cabinet with hinged doors (wooden bakery cases) SHKH-R-N-820 bakery cases

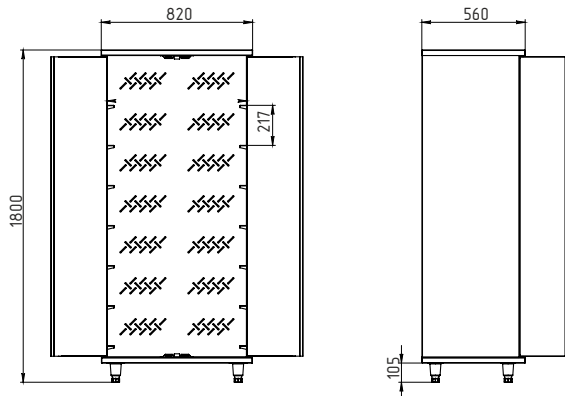

Description:

The kitchen cabinet with double hinged doors. Fitted with 7 guides for bakery cases mounting (740x450x70 mm.) The bakery cases are not included in the delivery set and are supplied separately. The cabinet is made of stainless steel AISI 430, It has legs adjustable by height. The product is supplied disassembled. Packing is corrugated board.

Length, mm	Width, mm	Height, mm	Material: painted steel	Dealer Price (EXW), \$
820	560	1800-1820	SHKH-R-N	461,7



Kitchen shelves

Shelves for kitchen cutting boards

Shelf for kitchen cutting boards PKND-4-N

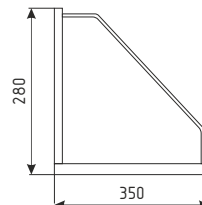
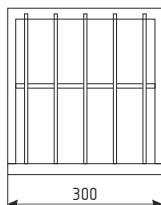

Shelf for kitchen cutting boards PKND-9-N

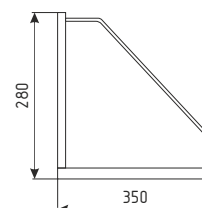
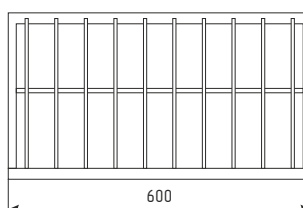

Shelf for kitchen cutting boards PKND-5-N

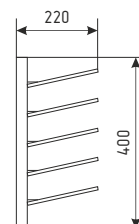
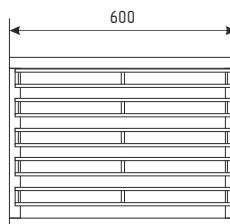

Description:

The shelf is intended for kitchen cutting boards storing. The foundation of shelf is made of stainless steel grade AISI 430, dividing elements are made of stainless steel grade AISI 304. The shelf is wall-mounted. The product is supplied assembled. Packing is stretch wrap.

Number of breads	Item code	Length, mm	Width, mm	Height, mm	Dealer Price (EXW), \$
4	PKND-4-N	300	350	280	41
5	PKND-5-N	600	220	400	45,6
9	PKND-9-N	600	350	280	58,1

Shelves for lids

Shelf for lids PKK-N-900

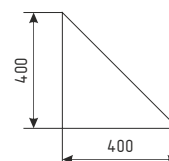
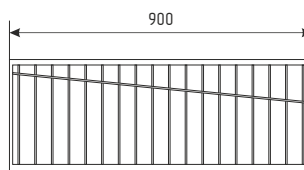

Description:

The shelf is intended for lids storing. Made of stainless steel grade AISI 430. The shelf is wall-mounted. The product is supplied assembled. Packing is stretch wrap.

Number of lids	Item code	Length, mm	Width, mm	Height, mm	Dealer Price (EXW), \$
17	PKK-N-900	900	400	400	74,1



Kitchen shelf, open type PKO

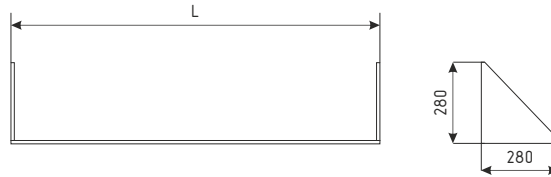

Description:

The kitchen shelf is made of stainless steel grade AISI 430. The shelf is wall-mounted. The product is supplied disassembled. Packing is corrugated board.

Kitchen shelf, closed type PKZ

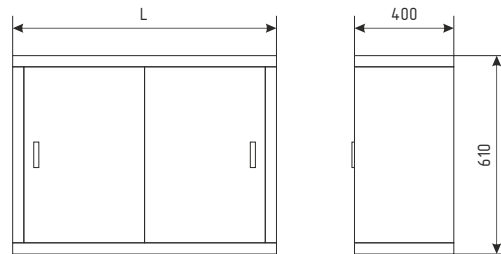

Description:

The kitchen shelf is made of stainless steel grade AISI 430. The shelf is fitted with white plastic sliding doors. The shelf is wall-mounted. The product is supplied assembled. Packing is stretch wrap.

Type	Item code	Length, L, mm	Width, mm	Height, mm	Dealer Price (EXW), \$
Open (PKO)	PKO-800x280	800	280	280	17,1
	PKO-900x280	900			18,2
	PKO-1000x280	1000			18,2
	PKO-1200x280	1200			21,7
	PKO-1500x280	1500			25,1
Closed (PKZ)	PKZ-800	800	400	610	112,9
	PKZ-900	900			122
	PKZ-1000	1000			123,1
	PKZ-1200	1200			139,1
	PKZ-1500	1500			159,6

Stands for equipment and utensils

Stand for air-o-steam ovens PK-12

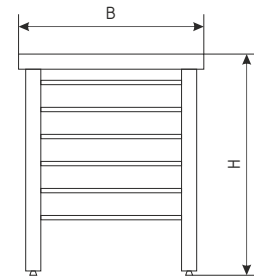
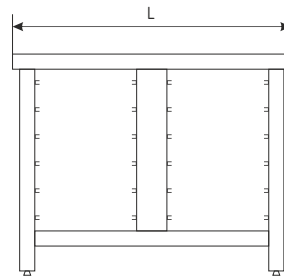

Description:

The stand is intended for air-o-steam oven mounting. Fitted with guides for gastronorm pans GN1/1 mounting. Made of stainless steel AISI 430. Welded frame is made of pipe (square section 40x40 mm). The product is supplied assembled. Packing is stretch wrap

Item code	Number of levels	Distance between levels	Length L, mm	Width B, mm	Height H, mm	Dealer Price (EXW), \$
PK-6V-M	6	85	840	700	910-930	135,7
PK-12	12	65	845	724	716	136,8

Stand for combi steam oven PKM

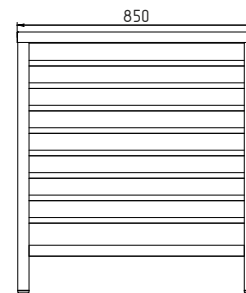
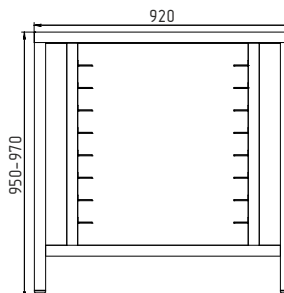
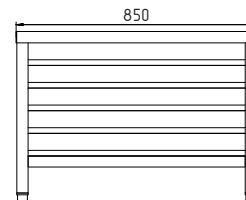
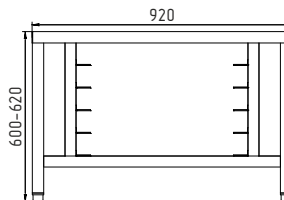
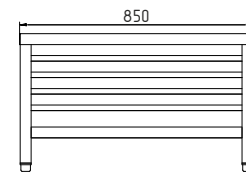
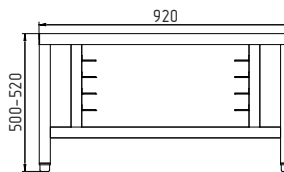

Description:

The stand is intended for air-o-steam oven mounting. Made of stainless steel AISI 430. Welded frame is made of pipe (square section 40x40 mm). The product is supplied assembled. Packing is stretch wrap

Item code	Number of levels	Weight, kg	Length L, mm	Width B, mm	Height H, mm	Dealer Price (EXW), \$
PKM-4	4	19,3	920	850	500(520)	104,9
PKM-5	5	21,3			600(620)	109,4
PKM-8	8	27,6			950(970)	117,4



Stand for pizza ovens PP 44

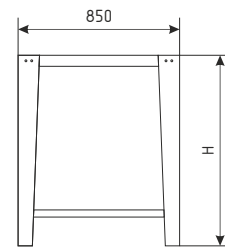
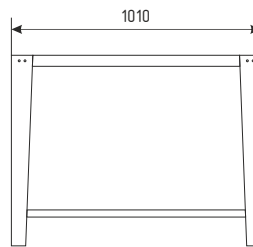

Description:

The stand is intended made of pizza oven mounting. Made of mild steel painted with black resistant paint. The product is supplied disassembled. Packing is corrugated board.

Type	Item code	Length, mm	Width, mm	Height H, mm	Dealer Price (EXW), \$
for single oven 4 pizzas	PP 4	1010	850	980	51,3
for double oven 4x4 pizzas	PP 44			850	49

Equipment Spacer VT

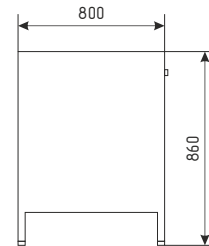
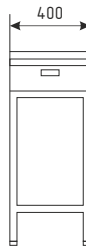

Description:

The unit is a support equipment. The tabletop and the drawer are made of stainless steel AISI 430; the other elements are made of mild steel painted with grey resistant paint.

Item code	Length, mm	Width, mm	Height H, m	Dealer Price (EXW), \$
VT	400	800	860	106

Ricker

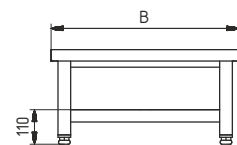
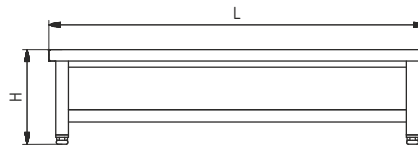

Description:

Rickers depending on the manufacturing material are produced in three series: ECONOM, STANDARD, and PROFI. ECONOM: Frame - mild steel pipe 40x40- and tabletop are made of mild steel painted with grey resistant paint.

STANDARD: Frame - pipe 40x40 of mild steel painted with grey powder paint. Tabletop is made of stainless steel AISI 430.

PROFI: Frame - pipe 40x40- and tabletop are made of stainless steel AISI 430.

All rickers are equipped with legs adjustable by height. The product is supplied disassembled. Packing is corrugated board.

Length L, mm	Width B, mm	Height H, mm	Series ECONOM		Series STANDARD		Series PROFI	
			Frame (painted steel)	Dealer Price (EXW), \$	Frame (painted) Tabletop (stainless steel AISI430)	Dealer Price (EXW), \$	Frame (entirely stainless steel AISI 430)	Dealer Price (EXW), \$
400	400	420	PMO-4/4	25,1	PMK-4/4	30,8	PMN-4/4	37,6
1000	600	300	PMO-10/6	46,7	PMK-10/6	85,5	PMN-10/6	93,5
1200			PMO-12/6	49	PMK-12/6	87,8	PMN-12/6	109,4
1200	800		PMO-12/8	50,2	PMK-12/8	90,1	PMN-12/8	116,3
1500			PMO-15/8	50,2	PMK-15/8	92,3	PMN-15/8	112,9

Equipment stand

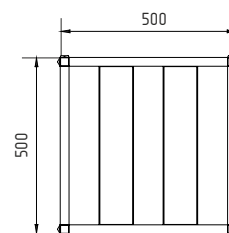
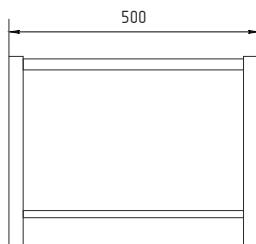

Description:

Used to set a variety of equipment . Made of a mild steel pipe 25x25 mm., painted with grey resistant paint. Supplied fully assembled. Packaging : stretch wrap.

Item code	Length, mm	Width, mm	Height, mm	Dealer Price (EXW), \$
PKO-E	500	500	355-375	27,4

Boiler stand

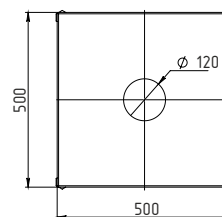
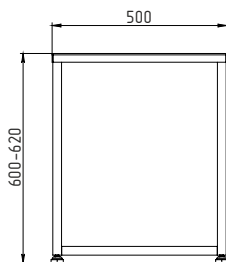

Description:

The stand is used for boiler installation. In the centre of the tabletop, there is an opening for connecting the boiler to the water supply. The frame is made of mild steel pipe 25x25 mm. (PKI-O - painted with grey resistant paint, PKI-N - stainless steel AISI 430) . The product is supplied assembled. Packing is stretch wrap.

Item code	Length, mm	Width, mm	Height, mm	Dealer Price (EXW), \$
PKI-O	500	500	600-620	26,2
PKI-N	500	500	600-620	51,3



Trolleys

Goods trolley TT-500

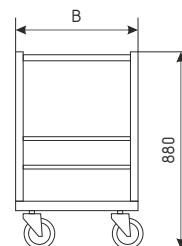
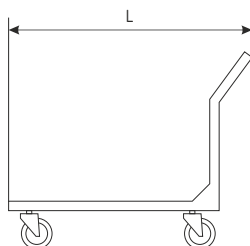

Goods trolley TT-200

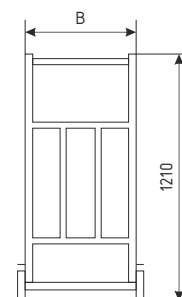
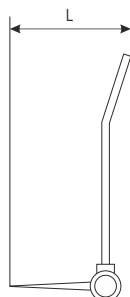

Description:

The trolleys are intended for transportation of bulky heavy goods. Depending on the load capacity, they are equipped with two or four wheels. 4-wheeled models are equipped with a stopper on one wheel. They are made of mild steel painted with grey resistant paint. The product is supplied assembled. Packing is stretch wrap.

Carrying capacity, kg	Item code	Number of wheels	Length, L, mm	Width, B, mm	Height, mm	Dealer Price (EXW), \$
200	TT-200	2	580	440	1210	46,7
300	TT-300	4	1100	630	880	78,7
500	TT-500	4	1530			118,6

Food serving cart (waiter's cart)

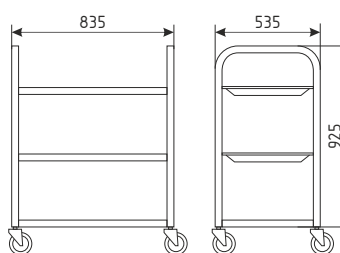

Description:

The trolleys are produced in two series: ECONOM and STANDARD.

ECONOM series: Frame – pipe 20x20. Shelves a made of stainless steel 0,8mm, the entire item is painted with grey resistant paint.

STANDARD series: Frame -pipe 20x20, shelves from stainless steel AISI 430 0,6 mm thickness.

Available in two variants: with two or three shelves with border height 30 and 80 mm. Equipped with 4 turning wheels, one of which has a stopper.

The product is supplied assembled. Packing is stretch wrap

Number of shelves	Border height, mm	Series ECONOM		Series STANDARD		Dimensions (LxWxH), mm
		Entirely painted steel	Dealer Price (EXW), \$	Stainless steel AISI 430	Dealer Price (EXW), \$	
2	30	TOO-2	53,6	TON-2	87,8	835x535x925
3		TOO-3	60,4	TON-3	108,3	835x535x925
2 (for dish collecting)	80	-	-	TOSpb-2	100,3	735x535x925



Rack trolleys

Rack trolleys are used for installation and transportation of gastronorm pans sizes GN 2/1, GN 1/1, baking sheets or trays sized 600x400 or trays with dirty dishes.

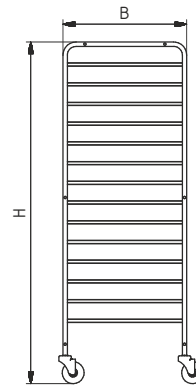
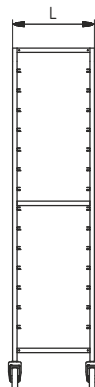

Description:

Rack trolley TSH-11

Made of stainless steel AISI 430, equipped with 4 wheels, one of which has a stopper. 14 levels are available. Can hold 14 gastronorm pans size GN 1/1 or 28 gastronorm pans size GN 1/2. The product is supplied disassembled. Packing is corrugated board.

Rack trolley TSH-21

Made of stainless steel AISI 430, equipped with 4 wheels, one of which has a stopper. 14 levels are available. Can hold 14 gastronorm pans size GN 2/1 or 28 gastronorm pans size GN 1/1. The product is supplied disassembled. Packing is corrugated board.

Rack trolley TSH-P12

Made of stainless steel AISI 430, equipped with 4 wheels, one of which has a stopper. 12 levels are available to hold 14 baking sheets or trays sized 600x400. The product is supplied disassembled. Packing is corrugated board.

Rack trolley TSH

Made of stainless steel AISI 430 or painted steel, equipped with 4 wheels, one of which has a stopper. 9 levels are available to hold trays with dirty dishes sized 400...410x310 mm. The structure is undismountable. Packing is corrugated board..

Type	Number of levels	Distance between levels, mm	Material	Item code	Length L, mm	Width B, mm	Height H, mm	Dealer Price (EXW), \$
For gastronorm pans sizes GN 1/1 and 1/2	14	90	Stainless steel AISI 430	TSH-11	373	565	1560	156,2
For gastronorm pans sizes GN 2/1 and 1/1				TSH-21	575	685		169,9
For baking sheets sized 600x400 mm	12	110		TSH-P12	650	430		176,7
For trays sized 400...410x310 mm	9	140		TSH-N	470	365		1500
			TSH-O	75,2				
			Painted steel					

Range Hood

Range Hood (wall-mounted)

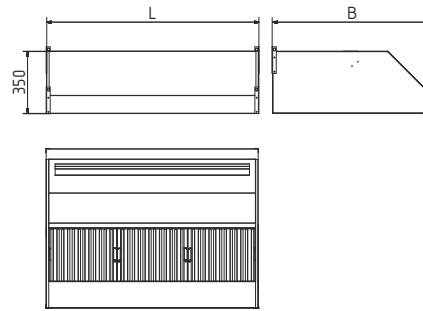

Description:

Made of stainless steel grade AISI 430 entirely. Can be supplied with or without fan or lighting. Price on request.

Range hood wall-mounted without fan and lighting

Item code	Length L, mm	Width B, mm	Height, mm	Dealer Price (EXW), \$
Labyrinth grease filter, highlight (option)				
ZV-P8/8	800	800	350	POR
ZV-P8/9	900			
ZV-P8/10	1000			
ZV-P8/12	1200			
ZV-P8/14	1400			
ZV-P9/9	900	900		
ZV-P9/10	1000			
ZV-P9/12	1200			
ZV-P9/14	1400			
ZV-P10/10	1000	1000		
ZV-P10/12	1200			
ZV-P10/16	1600	1200		
ZV-P12/12	1200			
ZV-P12/16	1600			

Range hood wall-mounted with fan and lighting

Item code	Length L, mm	Width B, mm	Height, mm	Dealer Price (EXW), \$
Labyrinth grease filter				
ZVe-P8/9	900	800	350	POR
ZVe-P8/10	1000			
ZVe-P8/12	1200			
ZVe-P8/14	1400			
ZVe-P9/9	900	900		
ZVe-P9/10	1000			
ZVe-P9/12	1200			
ZVe-P9/14	1400			

Hoods

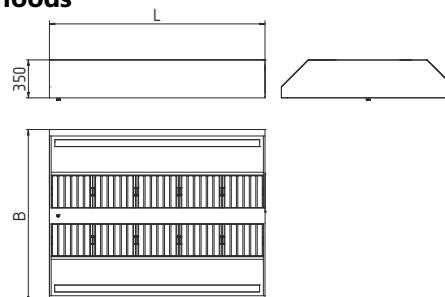

Description:

Made of stainless steel grade AISI 430 entirely. Can be supplied with or without fan or lighting. Price on request.

Range hood wall-mounted without fan and lighting

Item code	Length L, mm	Width B, mm	Height, mm	Dealer Price (EXW), \$
Labyrinth grease filter				
ZVO-P12/9	900	1200	350	POR
ZVO-P12/12	1200			
ZVO-P12/14	1400			
ZVO-P16/16	1600	1600		
ZVO-P16/20	2000			

Head office:

Russia, Krasnodar, 68/1 Rostovskoye Shosse Str.

Tel.: 8 (861) 228-98-23

E-mail: exp@zavod-pt.ru, export@zavod-pt.ru, export1@zavod-pt.ru

www.zavod-pt.ru